

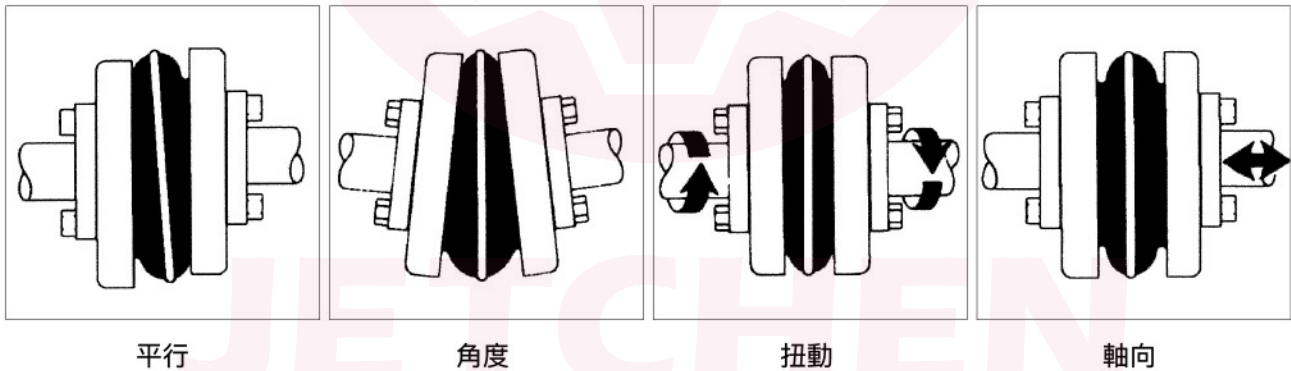

Quadra-Flex<sup>®</sup> 膠齒聯軸器，無須潤滑，免維修保養，安裝簡易方便。  
同時可應付各種衝擊負載，震動和軸間位移。



膠齒聯軸器在無磨損和最低磨耗的情況下，補償平行偏移量。從規格5的0.4mm至規格16的1.5mm。這樣可將徑向負載，在有平行位移時降至最低。

因彈性體的撓性和齒間之聯結作用，Quadra-Flex<sup>®</sup> 膠齒聯軸器可輕易地應付高達1°的角度位移而不出現明顯磨損。

膠齒彈性體具有扭曲緩衝性，所以很適合用於吸收衝擊震動，以避免其在設備間之傳遞。

膠齒的軸向彈性，容許聯軸器接受一定量的軸向位移，而降低對軸向衝擊負荷。膠齒套能承受軸向移動達3mm。

### QUADRA-FLEX®

#### 額定功率

#### TPR, EPDM, Neoprene Sleeves

HP	860 RPM Motor					1160 RPM Motor					1750 RPM Motor					3500 RPM Motor				
	Service Factors					Service Factors					Service Factors					Service Factors				
	1.0	1.25	1.5	2.0	2.5	1.0	1.25	1.5	2.0	2.5	1.0	1.25	1.5	2.0	2.5	1.0	1.25	1.5	2.0	2.5
1/2	3	3	3	4	4	3	3	3	3	4	3	3	3	3	3	—	—	—	—	—
3/4	3	4	4	4	5	3	3	4	4	4	3	3	3	3	4	3	3	3	3	3
1	4	4	4	5	5	3	4	4	4	5	3	3	3	4	4	3	3	3	3	3
1 1/2	4	5	5	5	6	4	4	5	5	5	3	4	4	4	5	3	3	3	3	4
2	5	5	5	6	6	4	5	5	5	6	4	4	4	5	5	3	3	3	4	4
3	5	6	6	6	7	5	5	6	6	6	4	5	5	5	6	3	4	4	4	5
5	6	6	7	7	8	6	6	6	7	7	5	5	6	6	6	4	4	5	5	5
7 1/2	7	7	8	8	9	6	7	7	8	8	6	6	6	7	7	5	5	5	6	6
10	7	8	8	9	9	7	7	8	8	9	6	6	7	7	8	5	5	6	6	6
15	8	9	9	10	10	8	8	9	9	10	7	7	8	8	9	6	6	6	7	7
20	9	9	10	10	11	8	9	9	10	10	7	8	8	9	9	6	6	7	7	8
25	9	10	10	11	11	9	9	10	10	11	8	8	9	9	10	6	7	7	8	8
30	10	10	11	11	12	9	10	10	11	11	8	9	9	10	10	7	7	8	8	9
40	10	11	11	12	12	10	10	11	11	12	9	9	10	10	11	7	8	8	9	9
50	11	11	12	12	13	10	11	11	12	12	9	10	10	11	11	8	8	9	9	10
60	11	12	12	13	13	11	11	12	12	13	10	10	11	11	12	8	9	9	10	10
75	12	12	13	13	14	11	12	12	13	13	10	11	11	12	12	9	9	10	10	11
100	12	13	13	14	14	12	12	13	13	14	11	11	12	12	13	9	10	10	11	11
125	13	13	14	14	—	12	13	13	14	14	11	12	12	13	13	10	10	11	11	—
150	13	14	14	16	16	13	13	14	14	16	12	12	13	13	14	10	11	11	—	—
200	14	14	16	16	16	13	14	14	16	16	12	13	13	14	14	11	11	—	—	—
250	14	16	16	16	16	14	14	16	16	16	13	13	14	14	—	11	—	—	—	—
300	16	16	16	16	—	14	16	16	16	16	13	14	14	—	—	—	—	—	—	—
350	16	16	16	—	—	16	16	16	16	16	14	14	—	—	—	—	—	—	—	—
400	16	16	16	—	—	16	16	16	16	—	14	14	—	—	—	—	—	—	—	—
450	16	16	—	—	—	16	16	16	—	—	14	—	—	—	—	—	—	—	—	—
500	16	16	—	—	—	16	16	16	—	—	14	—	—	—	—	—	—	—	—	—
600	16	—	—	—	—	16	16	16	—	—	—	—	—	—	—	—	—	—	—	—
700	—	—	—	—	—	16	16	—	—	—	—	—	—	—	—	—	—	—	—	—
800	—	—	—	—	—	16	—	—	—	—	—	—	—	—	—	—	—	—	—	—

### QUADRA-FLEX®

#### 額定功率

#### Hyrel Sleeves

HP	860 RPM Motor					1160 RPM Motor					1750 RPM Motor					3500 RPM Motor				
	Service Factors					Service Factors					Service Factors					Service Factors				
	1.0	1.25	1.5	2.0	2.5	1.0	1.25	1.5	2.0	2.5	1.0	1.25	1.5	2.0	2.5	1.0	1.25	1.5	2.0	2.5
1																				
1 1/2																				
2																				
3																				
5																				
7 1/2	6H	6H	6H	6H	6H	—	—	—	—	—	—	—	—	—	—	—	—	—	—	—
10	6H	6H	6H	6H	6H	6H	6H	6H	6H	6H	—	—	—	—	—	—	—	—	—	—
15	6H	6H	6H	7H	7H	6H	6H	6H	6H	7H	6H	6H	6H	6H	6H	—	—	—	—	—
20	6H	6H	7H	7H	8H	6H	6H	6H	7H	7H	6H	6H	6H	6H	6H	—	—	—	—	—
25	6H	7H	7H	8H	8H	6H	6H	7H	7H	8H	6H	6H	6H	6H	7H	—	—	—	—	—
30	7H	7H	8H	8H	9H	6H	7H	7H	8H	8H	6H	6H	6H	7H	7H	6H	6H	6H	6H	6H
40	7H	8H	8H	9H	9H	7H	7H	8H	8H	9H	6H	6H	7H	7H	8H	6H	6H	6H	6H	6H
50	8H	8H	9H	9H	10H	7H	8H	8H	9H	9H	6H	7H	7H	8H	8H	6H	6H	6H	6H	7H
60	8H	9H	9H	10H	10H	8H	8H	9H	9H	10H	7H	7H	8H	8H	9H	6H	6H	6H	7H	7H
75	9H	9H	10H	10H	11H	8H	9H	9H	10H	10H	7H	8H	8H	9H	9H	6H	6H	7H	7H	8H
100	9H	10H	10H	11H	11H	9H	9H	10H	10H	11H	8H	8H	9H	9H	10H	6H	7H	7H	8H	8H
125	10H	10H	11H	11H	12H	9H	10H	10H	11H	11H	8H	9H	9H	10H	10H	7H	7H	8H	8H	9H
150	10H	11H	11H	12H	12H	10H	10H	11H	11H	12H	9H	9H	10H	10H	11H	7H	8H	8H	9H	9H
200	11H	11H	12H	12H	13H	10H	11H	11H	12H	12H	9H	10H	10H	11H	11H	8H	8H	9H	9H	10H
250	11H	12H	12H	13H	13H	11H	11H	12H	12H	13H	10H	10H	11H	11H	12H	8H	9H	9H	10H	10H
300	12H	12H	13H	13H	14H	11H	12H	12H	13H	13H	10H	11H	11H	12H	12H	9H	9H	10H	10H	11H
350	12H	12H	13H	14H	14H	12H	12H	12H	13H	14H	11H	11H	12H	12H	12H	9H	10H	10H	11H	11H
400	12H	13H	13H	14H	14H	12H	12H	13H	13H	14H	11H	11H	12H	12H	13H	9H	10H	10H	11H	11H
500	13H	13H	14H	14H	—	12H	13H	13H	14H	14H	11H	12H	12H	13H	13H	10H	10H	11H	11H	—
600	13H	14H	14H	—	—	13H	13H	13H	14H	—	12H	12H	13H	13H	14H	10H	11H	11H	—	—
700	14H	14H	—	—	—	13H	13H	14H	14H	—	12H	12H	13H	14H	14H	11H	11H	—	—	—
800	14H	14H	—	—	—	13H	14H	14H	—	—	12H	13H	13H	14H	14H	11H	11H	—	—	—
900	14H	—	—	—	—	14H	14H	14H	—	—	13H	13H	14H	14H	—	11H	—	—	—	—
1000	—	—	—	—	—	14H	14H	—	—	—	13H	13H	14H	14H	—	11H	—	—	—	—

### QUADRA-FLEX® Sleeves

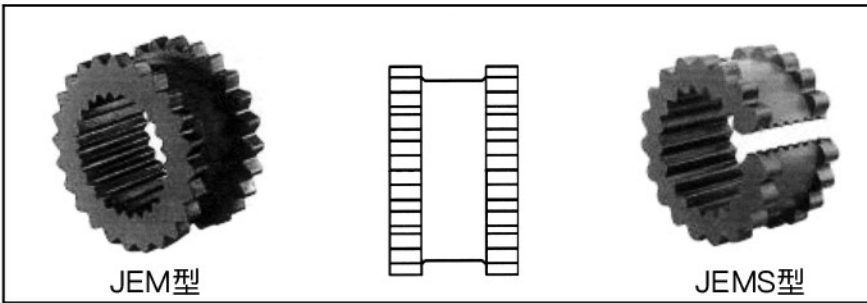

JEM型

JEMS型

Types JEM — JEMS

JEM一件體型號

JEMS - 有開口一件體型號

材質TPR 熱塑性橡膠

TPR可承受大範圍溫差和耐油性。

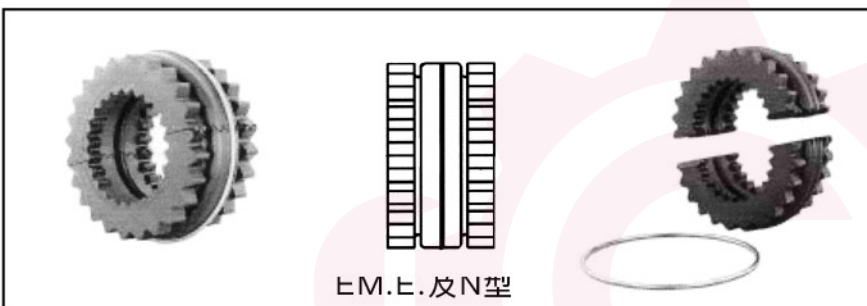

EM, E, 及 N型

Types EM — E — N

EM, E, N 彈性體均由兩個半月形膠圈和一個固定環所組成，材質TPR .EPDM 和 Neoprene 熱塑性橡膠，這些同規格彈性體可用於不同設計法蘭。

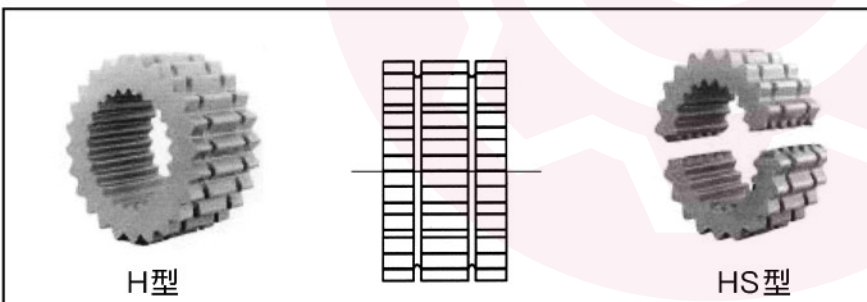

H型

HS型

Types H & HS

H一件體型號

HS - 有開口二件體型號

材質 Hytrel 塑性橡膠

Hytrel 塑性橡膠能承受更高扭矩。

### Dimensions

(mm)

規格	JEM — JEMS			EM			E and N Sleeves			H & HS Sleeves			Maximum rpm
	Sleeves			Sleeves			EDPM and Neoprene			Hytrel			
	D	W	Wt. (Kg.)	D	W	Wt. (Kg.)	D	W	Wt. (Kg.)	D	W	Wt. (Kg.)	
3	47.6	25.4	0.03	—	—	—	—	—	—	—	—	—	9200
4	58.7	31.8	0.05	58.7	31.8	0.05	—	—	—	—	—	—	7600
5	74.6	39.7	0.09	74.6	39.7	0.11	—	—	—	—	—	—	7600
6	95.3	47.6	0.18	95.3	47.6	0.22	—	—	—	95.3	47.6	0.20	6000
7	110.3	55.5	0.28	110.3	55.6	0.35	—	—	—	110.3	55.5	0.31	5250
8	128.6	63.5	0.51	128.6	63.5	0.64	—	—	—	128.6	63.5	0.64	4500
9	152.4	76.2	0.66	152.4	76.2	0.91	—	—	—	152.4	76.2	0.82	3750
10	179.4	87.3	1.05	179.4	87.3	1.45	—	—	—	179.4	87.3	1.32	3600
11	—	—	—	—	—	—	207.9	101.6	2.31	207.9	101.6	2.04	3600
12	—	—	—	—	—	—	242.9	119.0	3.68	242.9	119.0	3.31	2800
13	—	—	—	—	—	—	284.1	139.7	5.90	284.1	139.7	5.35	2400
14	—	—	—	—	—	—	332.6	165.1	9.57	332.6	165.1	8.76	2200
16	—	—	—	—	—	—	454.8	222.3	20.55	—	—	—	1500



## S-Flanges 膠齒聯軸器

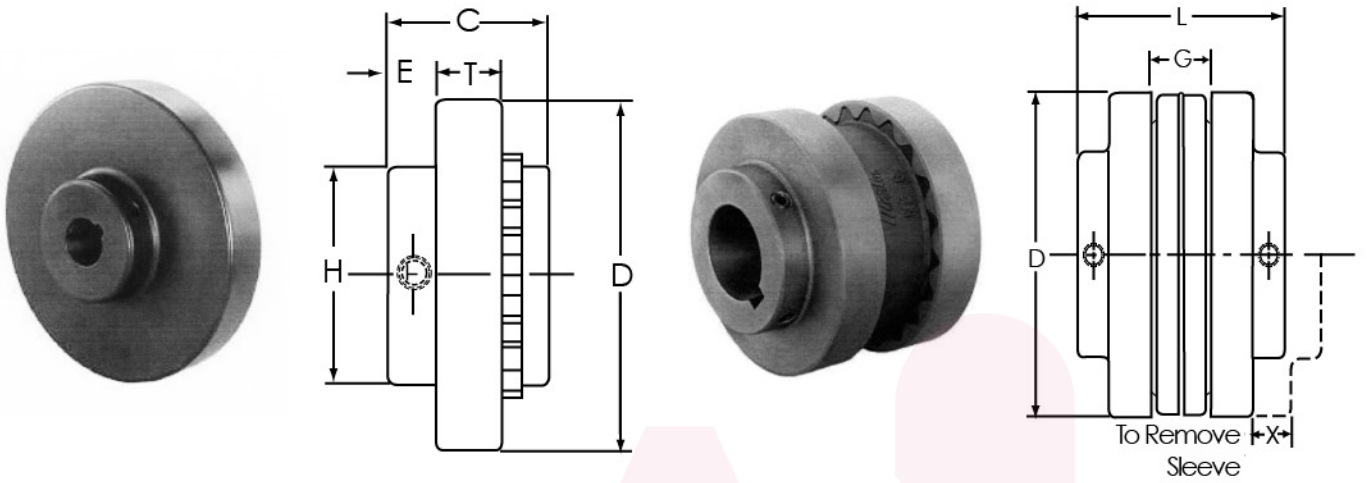

### QUADRA-FLEX®

J型法蘭 – 粉末冶金

(mm)

規格	最大孔徑	C	D	E	G	H	L	T	X	重量 (Kg)
3J	19	20.6	52.4	11.1	9.5	38.1	50.8	9.5	14.3	0.12
3J	22	20.6	52.4	11.1	9.5	38.1	50.8	9.5	14.3	0.12
4J	25	22.2	62.5	11.1	15.9	41.3	60.3	11.1	19.1	0.21
5J	28	27.0	82.6	11.9	19.1	47.6	73.0	15.1	24.6	0.39
6J	35	31.0	101.6	15.1	22.2	49.2	84.1	15.9	27.8	0.78

S型法蘭 – GG25高強度鑄鐵

(mm)

規格	D	最大孔徑	H	C	E	G	L	T	X	重量 (Kg)
5S	82.6	30.2	47.6	34.1	11.5	19.1	71.4	15.1	24.6	0.45
6S	101.6	36.5	63.5	41.3	13.5	22.2	88.9	19.8	27.8	0.95
	101.6	—	63.5	33.3	13.5	22.2	88.9	19.8	27.8	0.95
7S	101.6	—	71.4	39.7	19.8	22.2	101.6	19.8	27.8	0.95
	117.5	41.3	71.4	46.8	17.5	25.4	100.0	19.8	33.3	1.23
8S	138.4	49.2	82.6	53.2	19.1	28.6	112.7	23.0	38.1	2.04
	138.4	—	82.6	49.2	26.2	28.6	127.0	23.0	38.1	2.04
9S	161.3	60.3	92.1	61.1	19.8	36.5	128.6	26.2	44.5	2.95
	161.3	—	104.8	57.9	31.8	36.5	152.4	26.2	44.5	2.95
10S	190.5	69.9	111.1	67.5	20.6	41.3	144.5	31.0	50.8	5.13
	190.5	—	120.7	68.3	37.3	41.3	177.8	31.0	50.8	5.13
11S	219.1	57.2	95.3	87.3	28.6	47.6	181.0	38.1	60.3	7.99
	219.1	73.0	123.8	87.3	28.6	47.6	181.0	38.1	60.3	7.99
	219.1	85.7	133.4	87.3	28.6	47.6	181.1	38.1	60.3	7.99
	219.1	—	142.9	77.8	39.7	47.6	203.2	38.1	60.3	7.99
12S	254.0	57.2	95.3	101.6	32.5	58.7	209.6	42.9	68.3	12.34
	254.0	73.0	123.8	101.6	32.5	58.7	209.6	42.9	68.3	12.34
	254.0	98.4	146.1	101.6	32.5	58.7	209.6	42.9	68.3	12.34
13S	298.5	73.0	123.8	111.1	33.3	68.3	235.0	50.0	77.8	20.69
	298.5	114.3	171.5	111.1	33.3	68.3	235.0	50.0	77.8	20.69
14S	352.4	73.0	123.8	114.3	27.0	82.6	250.8	57.2	88.9	31.76
	352.4	127.0	190.5	114.3	27.0	82.6	250.8	57.2	88.9	31.76
16S	479.4	139.7	203.2	152.4	50.8	120.7	362.0	69.9	108.0	57.17

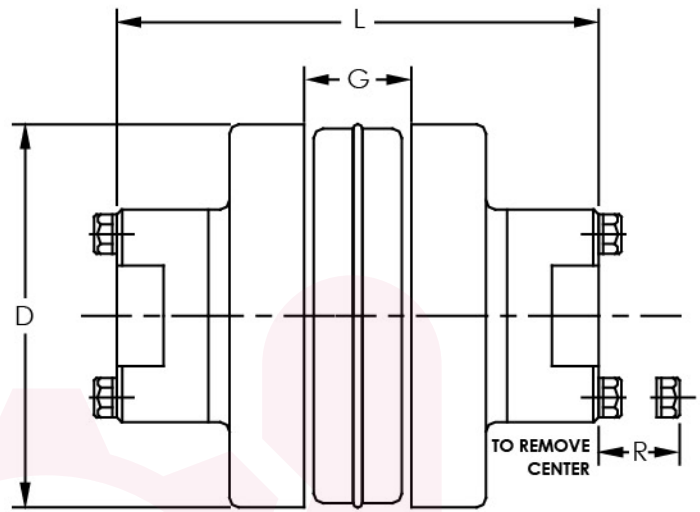

## QUADRA-FLEX<sup>®</sup> Spacer Couplings

規格	軸間距	法蘭	延伸器	最大孔徑	尺寸				重量 (Kg)
					D	L <sup>2</sup>	G	R	
4JSC	88.9	4JSC35	4H	28.6	62.5	142.9	15.9	12.7	2.13
5SC	88.9	5SC35	5H	28.6	82.6	142.9	19.1	14.3	1.86
6SC	88.9	6SC35	6H	34.9	101.6	149.2	22.2	19.1	3.22
	111.1	6SC44	6H	34.9	101.6	171.5	22.2	19.1	3.58
	127.0	6SC50	6H	34.9	101.6	187.3	22.2	19.1	3.86
	88.9	7SC35	7H	41.3	117.5	161.9	25.4	15.9	4.13
7SC	111.1	7SC44	7H	41.3	117.5	184.2	25.4	15.9	4.58
	127.0	7SC50	7H	41.3	117.5	200.0	25.4	15.9	4.85
8SC	88.9	8SC35	8H	47.6	138.4	174.6	28.6	20.6	6.67
	88.9	8SC35-10	10H	60.3	138.4	206.4	28.6	20.6	10.30
	111.1	8SC44	8H	47.6	138.4	196.9	28.6	20.6	7.30
	127.0	8SC50	8H	47.6	138.4	212.7	28.6	30.2	7.21
	127.0	8SC50-10	10H	60.3	138.4	244.5	28.6	30.2	12.02
9SC	88.9	9SC35	9H	54.0	161.3	190.5	36.5	27.0	9.98
	111.1	9SC44	9H	54.0	161.3	209.6	36.5	27.0	10.62
	127.0	9SC50	9H	54.0	161.3	225.4	36.5	27.0	11.16
	127.0	9SC50-11	11H	73.0	161.3	263.5	36.5	30.2	18.24
	177.8	9SC70-11	11H	73.0	161.3	314.3	36.5	30.2	21.87
	196.9	9SC78-11	11H	73.0	161.3	333.4	36.5	30.2	23.05
10SC	120.7	10SC48	10H	60.3	190.5	238.1	41.3	30.2	16.06
	127.0	10SC50	10H	60.3	190.5	244.5	41.3	30.2	17.33
	177.8	10SC70-13	13H	85.7	190.5	346.1	41.3	47.6	32.58
	196.9	10SC78-13	13H	85.7	190.5	365.1	41.3	47.6	34.30
	254.0	10SC100-13	13H	85.7	190.5	422.3	41.3	47.6	40.38
11SC	120.7	11SC48	11H	73.0	219.1	269.9	47.6	30.2	24.73
	127.0	11SC50	11H	73.0	219.1	263.5	47.6	30.2	24.86
	177.8	11SC70-14	14H	98.4	219.1	371.5	47.6	50.8	38.88
	196.9	11SC78-14	14H	98.4	219.1	390.5	47.6	50.8	40.88
	254.0	11SC100-14	14H	98.4	219.1	447.7	47.6	50.8	46.51
12SC	177.8	12SC70	12H	73.0	254.0	327.0	58.7	38.1	39.79
	177.8	12SC70-14	14H	98.4	254.0	371.5	58.7	50.8	44.87
	196.9	12SC78	12H	73.0	254.0	346.1	58.7	38.1	41.52
	196.9	12SC78-14	14H	98.4	254.0	390.5	58.7	50.8	46.87
	254.0	12SC100-14	14H	98.4	254.0	447.7	58.7	50.8	52.40
13SC	196.9	13SC78	13H	85.7	298.5	365.1	68.3	47.6	55.26
14SC	196.9	14SC78	14H	98.4	352.4	390.5	82.6	50.8	81.40

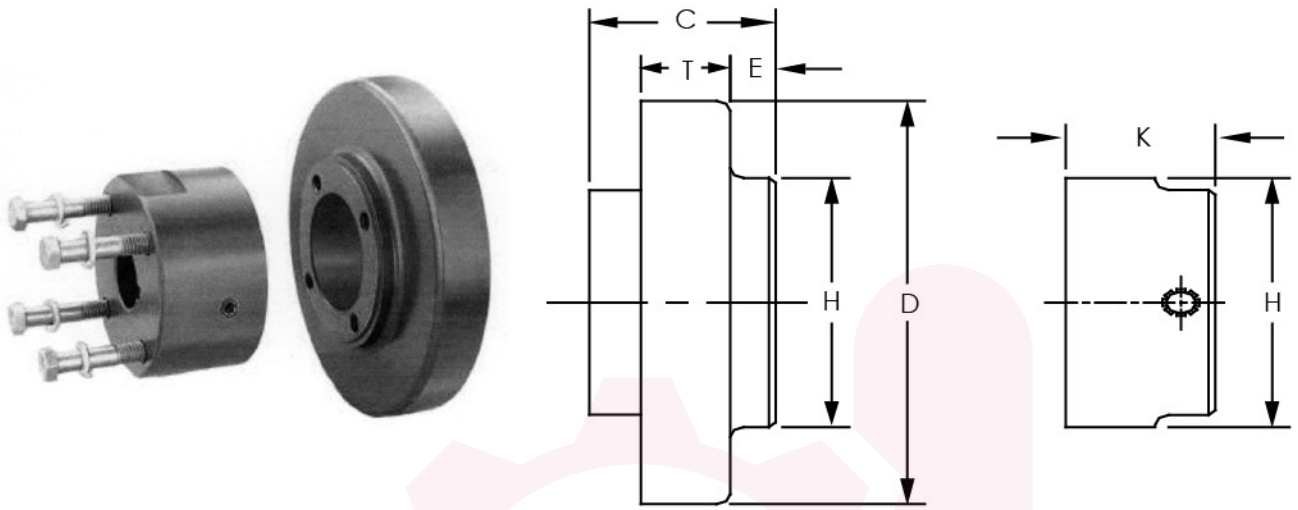

SC- Flanges and hubs

聯軸器規格	法蘭	軸距	延伸器	尺寸					重量 (Kg)
				D	E	H	C	T	
4JSC	<b>4SC35</b>	88.9	<b>4H</b>	62.5	11.1	50.8	22.2	11.1	
5SC	<b>5SC35</b>	88.9	<b>5H</b>	82.6	20.2	50.8	42.9	15.1	0.54
6SC	<b>6SC35</b>	88.9	<b>6H</b>	101.6	14.5	63.5	41.3	19.1	0.91
	<b>6SC44</b>	111.1	<b>6H</b>	101.6	25.4	63.5	52.4	19.1	1.09
	<b>6SC50</b>	127.0	<b>6H</b>	101.6	33.3	63.5	60.3	19.1	1.23
7SC	<b>7SC35</b>	88.9	<b>7H</b>	117.5	11.9	71.4	41.3	19.8	1.04
	<b>7SC44</b>	111.1	<b>7H</b>	117.5	23.0	71.4	52.4	19.8	1.27
	<b>7SC50</b>	127.0	<b>7H</b>	117.5	31.0	71.4	60.3	19.8	1.41
8SC	<b>8SC35</b>	88.9	<b>8H</b>	138.4	7.1	82.6	41.3	23.0	1.59
	<b>8SC35-10</b>	88.9	<b>10H-10HS</b>	138.4	7.1	111.1	41.3	23.0	1.54
	<b>8SC44</b>	111.1	<b>8H</b>	138.4	18.3	82.6	52.4	23.0	1.91
	<b>8SC50</b>	127.0	<b>8H</b>	138.4	26.2	82.6	60.3	23.0	2.09
	<b>8SC50-10</b>	127.0	<b>10H-10HS</b>	138.4	26.2	111.1	60.3	23.0	2.40
9SC	<b>9SC35</b>	88.9	<b>9H-9HS</b>	161.3	1.6	92.1	42.9	26.2	2.31
	<b>9SC44</b>	111.1	<b>9H-9HS</b>	161.3	11.1	92.1	52.4	26.2	2.63
	<b>9SC50</b>	127.0	<b>9H-9HS</b>	161.3	19.1	92.1	60.3	26.2	2.90
	<b>9SC50-11</b>	127.0	<b>11H-11HS</b>	161.3	19.1	133.4	60.3	26.2	3.13
	<b>9SC70-11</b>	177.8	<b>11H-11HS</b>	161.3	44.5	133.4	85.7	26.2	4.95
	<b>9SC78-11</b>	196.9	<b>11H-11HS</b>	161.3	54.0	133.4	95.3	26.2	5.49
10SC	<b>10SC48</b>	120.7	<b>10H-10HS</b>	190.5	8.7	111.1	57.2	31.0	4.45
	<b>10SC50</b>	127.0	<b>10H-10HS</b>	190.5	11.9	111.1	60.3	31.0	4.58
	<b>10SC70-13</b>	177.8	<b>13H-13HS</b>	190.5	37.3	155.6	85.7	31.0	6.58
	<b>10SC78-13</b>	196.9	<b>13H-13HS</b>	190.5	46.8	155.6	95.3	31.0	7.40
	<b>10SC100-13</b>	254.0	<b>13H-13HS</b>	190.5	75.4	155.6	123.8	31.0	10.21
11SC	<b>11SC48</b>	120.7	<b>11H-11HS</b>	219.1	1.3	133.4	38.1	38.1	5.67
	<b>11SC50</b>	127.0	<b>11H-11HS</b>	219.1	1.9	133.4	39.7	38.1	5.76
	<b>11SC70-14</b>	177.8	<b>14H</b>	219.1	27.0	165.1	65.1	38.1	7.30
	<b>11SC78-14</b>	177.8	<b>14H</b>	219.1	36.5	165.1	74.6	38.1	8.30
	<b>11SC100-14</b>	254.0	<b>14H</b>	219.1	65.1	165.1	103.2	38.1	11.12
12SC	<b>12SC70</b>	177.8	<b>12H-12HS</b>	254.0	16.7	146.1	62.7	42.9	10.53
	<b>12SC70-14</b>	177.8	<b>14H</b>	254.0	16.7	165.1	62.7	42.9	9.62
	<b>12SC78</b>	196.9	<b>12H-12HS</b>	254.0	26.2	146.1	72.2	42.9	11.39
	<b>12SC78-14</b>	196.9	<b>14H</b>	254.0	26.2	165.1	72.2	42.9	10.62
	<b>12SC100-14</b>	254.0	<b>14H</b>	254.0	54.8	165.1	100.8	42.9	13.38
13SC	<b>13SC78</b>	196.9	<b>13H-13HS</b>	298.5	14.3	155.6	82.6	50.0	17.42
14SC	<b>14SC78</b>	196.9	<b>14H</b>	352.4	1.0	165.1	69.1	57.2	24.95



## SC-延伸型膠齒聯軸器

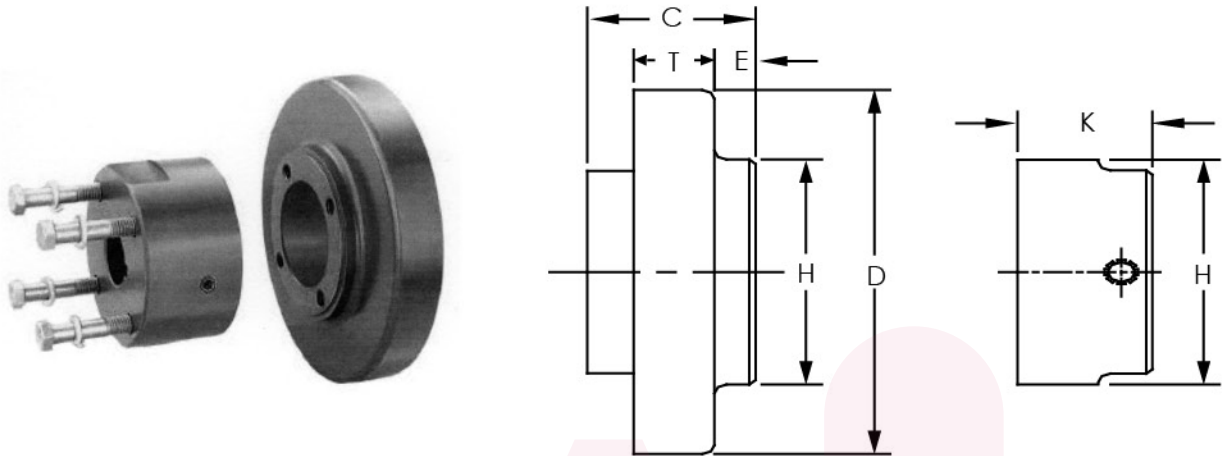

SC- Flanges and hubs

規格	輪殼	最大孔徑	最小孔徑	庫存孔徑	K (mm)	H (mm)	螺絲	重量 (Kg)
5SC	5H	28.6	1/2	5/8 - 3/4 - 7/8 - 1 - 1 1/8	27.8	50.8	4 — # 10 x 1 1/2	0.32
6SC	6H	34.9	5/8	3/4 - 7/8 - 1 - 1 1/8 - 1 1/4 - 1 3/8	31.0	63.5	4 — 1/4 x 1 3/4	0.59
7SC	7H	41.3	5/8	7/8 - 1 - 1 1/8 - 1 3/8 - 1 1/2 - 1 5/8	37.3	71.4	4 — 1/4 x 1 7/8	0.86
8SC	8H	47.6	3/4	7/8 - 1 - 1 1/8 - 1 3/8 - 1 1/2 - 1 5/8 - 1 3/4 - 1 7/8	43.7	82.6	4 — 5/16 x 2 1/4	1.45
9SC	9H	54.0	7/8	1 - 1 1/8 - 1 3/8 - 1 1/2 - 1 5/8 - 1 3/4 - 1 7/8 - 2 1/8	50.0	92.1	4 — 3/8 x 2 3/4	2.00
	9HS	38.1	...	1 1/8	38.9	92.1	4 — 3/8 x 2 1/4	1.68
10SC	10H	60.3	1 1/8	1 5/8 - 1 7/8 - 2 1/8 - 2 3/8	59.5	111.1	4 — 7/16 x 3	3.31
	10HS	41.3	...	1 1/8	42.1	111.1	4 — 7/16 x 2 1/2	2.50
11SC	11H	73.0	1 1/8	1 7/8 - 2 1/8 - 2 3/8 - 2 7/8	69.1	133.4	4 — 1/2 x 3 1/2	5.54
	11HS	47.6	...	1 1/8 - 1 5/8	48.4	133.4	4 — 1/2 x 2 3/4	4.22
12SC	12H	73.0	1 7/8	2 1/8 - 2 3/8 - 2 7/8	75.4	146.1	4 — 5/8 x 4	7.53
	12HS	63.5	...	2 3/8	64.3	146.1	4 — 5/8 x 3 1/2	6.40
13SC	13H	85.7	...	2 3/8 - 2 7/8 - 3 3/8	84.9	155.6	4 — 5/8 x 4 3/4	9.03
	13HS	63.5	...	2 1/8 - 2 3/8	62.7	155.6	4 — 5/8 x 3 1/2	7.26
14SC	14H	98.4	...	2 3/8 - 2 7/8 - 3 3/8 - 3 7/8	97.6	165.1	4 — 5/8 x 5	10.98

### 軸間距選擇

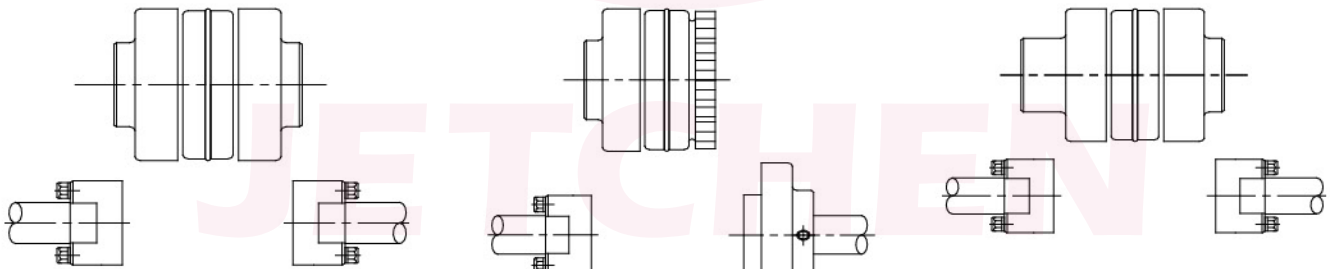

標準型

Standard	
Spacing	Use Flanges
88.9	2 - ( ) SC35
111.1	2 - ( ) SC44
127.0	2 - ( ) SC50
177.8	2 - ( ) SC70
196.9	2 - ( ) SC78
254.0	2 - ( ) SC100

混合型

Combination	
Spacing	Use Flanges
100.0	SC35 & SC44
108.0	SC35 & SC50
119.1	SC44 & SC50
133.4	SC35 & SC70
142.9	SC35 & SC78
144.5	SC44 & SC70
152.4	SC50 & SC70
154.0	SC44 & SC78
161.9	SC50 & SC78
171.5	SC35 & SC100
182.6	SC44 & SC100
187.3	SC70 & SC78
190.5	SC50 & SC100
215.9	SC70 & SC100
225.4	SC78 & SC100

半軸距

Semi-Spacer	
Spacing	Use Flanges
47.6	S & SC35
58.7	S & SC44
66.7	S & SC50
92.1	S & SC70
101.6	S & SC78
130.2	S & SC100





Parallel

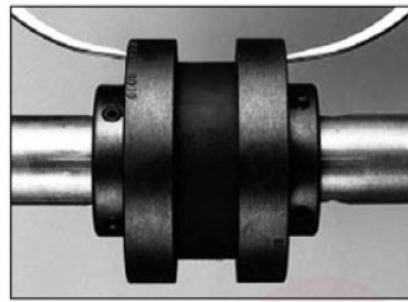

Angular

### 最大轉速和容許位移

mm

Handsome Yang

規格	最大轉速 (RPM)	型號 JEM, JEMS, EM, E				型號 H&HS			
		Y	軸向 A	角度 (b-a)	水平 P	Y	軸向 A	角度 (b-a)	水平 P
3	9200	31.7	0.89	0.9	0.25	-	-	-	-
4	7600	38.1	1.09	1.1	0.25	-	-	-	-
5	7600	49.2	1.42	1.4	0.40	-	-	-	-
6	6000	61.9	1.78	1.8	0.40	63.5	0.40	0.40	0.25
7	5250	65.1	2.06	2.1	0.50	66.7	0.50	0.50	0.30
8	4500	74.6	2.38	2.4	0.65	76.2	0.63	0.60	0.40
9	3750	88.9	2.77	2.8	0.65	90.5	0.71	0.70	0.40
10	3600	102.9	3.25	3.3	0.80	104.8	0.81	0.80	0.50
11	3600	123.8	3.83	3.8	0.80	125.4	0.94	0.90	0.56
12	2800	144.5	4.45	4.5	1.00	146.1	1.07	1.00	0.64
13	2400	169.9	4.95	5.0	1.10	169.9	1.27	1.25	0.76
14	2200	196.9	6.15	6.2	1.00	198.5	1.52	1.50	0.90
16	1500	260.4	8.38	8.4	1.60	-	-	-	-

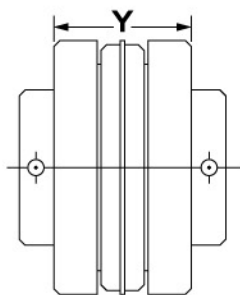

Torsional

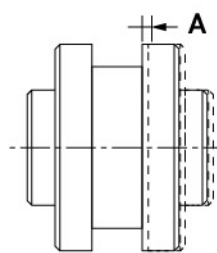

Axial

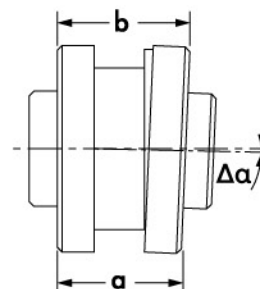

Angular

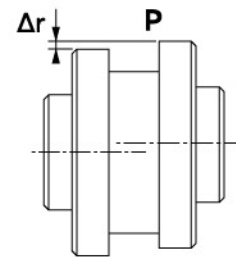

Parallel