



Power Transmission

2018優良商標獎  
2020台灣製造精品獎

# *Polyurethane* PU同步帶 *Timing Belts*



TRANSMIT POWER TO THE FUTURE 傳遞動能 · 傳遞未來

<b>02 PU同步帶 Polyurethane Timing Belts</b>	
03 產品說明	Product Description
04 齒型介紹	Type Introduction
05 訂購示例	Order Example
06 輸送應用	Conveying Applications
07 擋塊	Cleats
08 寬幅聚氨酯同步輸送帶	Extra-wide Polyurethane Timing Conveyor Belts
09 快拆式接合帶	Pin Belts
10 背膠	Coating
12 T型同步帶	T-Type (T2.5、T5、T10、T20)
16 AT型同步帶	AT-Type (AT3、AT5、AT5L、AT10、AT10L、AT20、AT20L)
23 英制同步帶	Inch Pitch-Type (MXL、XL、L、H、XH)
28 HTD同步帶	HTD-Type (3M、5M、8M、14M、14ML)
33 STD同步帶	STD-Type (S5M、S8M、S14M)
36 RPP同步帶	RPP-Type (P5M、P8M、P14M、P14ML)
40 底中導同步帶	Self Tracking Timing Belts (TK、ATK)
44 PU平面帶	Polyurethane Flat Belts (F1、F2、F2.5、F3)
<b>45 同步帶輪 Timing Pulleys</b>	
46 帶輪形式	Pulley Types
47 鍵槽與緊定螺絲孔	Keyway and Set Screw Holes
48 錐套	Taper Bushings
49 英制帶輪	Inch Pitch-Type (MXL、XL、L、H、XH)
54 T型帶輪	T-Type (T2.5、T5、T10、T20)
58 AT型帶輪	AT-Type (AT3、AT5、AT10、AT20)
62 公制帶輪	HTD、STD、RPP-Type (3M、5M、8M、14M、20M)
68 夾板	Clamp Plates
<b>測量儀器 Measuring Instrument</b>	
69 紅外線皮帶張力計	Precision Instrument for Measuring Belt Tension
70 工業級雷射對心儀	Industrial Laser Alignment Device

本公司保留對上述產品之型號、規格、尺寸的修訂權、終止權及最終解釋權，而無須做出任何通知。如有任何爭議，捷誠興業保留最終決定權。

JET CHEN SHIN YEN CO., LTD. reserves the right to amend, terminate and finally interpret the model, specifications and dimensions of the above products without any notice. In case of any disputes, JET CHEN SHIN YEN reserves the right of final decision.

### 產品介紹

- GAINER聚氨酯同步帶，具有高強度和良好的柔韌性，特別適用於直線運動和同步輸送系統。
- 可以接合成任意長度環型帶，滿足不同情況下的輸送用途。
- 提供皮帶開槽和打孔等服務，也可以在皮帶背面加工不同形狀擋塊。
- 不同功能的皮帶背膠加工，如PVC.PU.泡棉.尼龍布與特殊橡膠。

### PRODUCT INTRODUCTION

- GAINER polyurethane timing belts have high strength and good flexibility systems. Especially suitable for linear motion systems and synchronous conveying.
- Can be produced to any length of the endless belt to satisfy various conveying purposes in different situations.
- Provide belt notching, perforating services, etc. Different shapes of cleats processed on the back of the belt.
- Different features belts processed covering materials. For instance, PVC, PU, foam, nylon cloth and particular rubber.

### 產品特點

高精度  
良好的尺寸穩定性  
低噪音  
高耐磨  
良好的柔韌性  
免維護  
預拉力低  
直線速度可達80米/秒  
工作溫度-10℃~+80℃最高110℃  
耐油、耐脂  
耐部分酸和鹼  
耐老化、耐水解、耐臭氧

### PRODUCT CHARACTERISTICS

High precision  
Exceptional size stability  
Low noise  
High wear resistance  
Exceptional flexibility  
No maintenance  
Low pretension strength  
The linear velocity can reach 80m/s  
Working temperature -10℃~+80℃ (peaks up to 110℃)  
Resistant to oil and grease  
Resistant to some acids and alkali  
Aging resistance, hydrolysis resistance, and ozone resistance



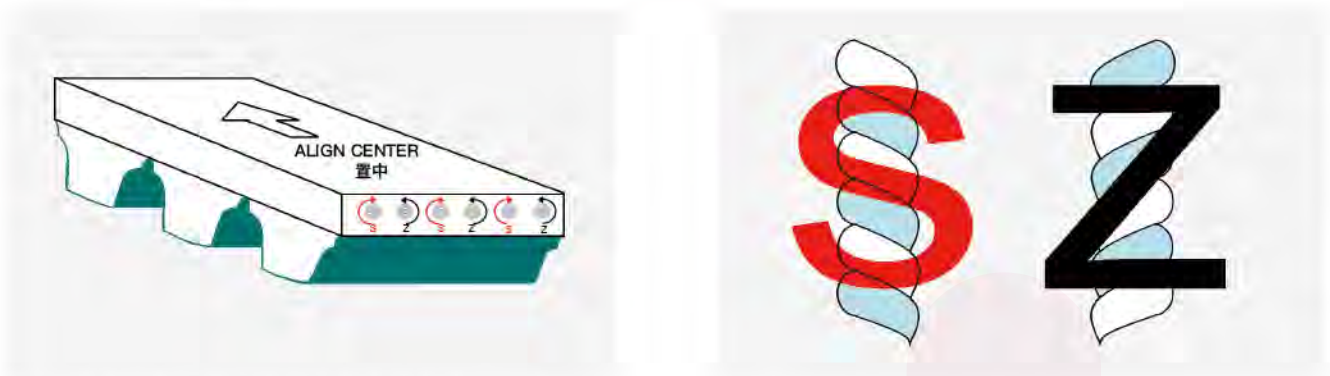

S和Z撚法芯線幫助同步皮帶在運轉軌道上定位。

Both S and Z twist tensile cords help the timing belts to position on the running track.

使用S和Z撚法的皮帶在一個方向軌道穩定運轉。

The belt using the S and Z twisted tensile runs stably in one direction track.

#### 雙撚的芯線 Double twist tensile members

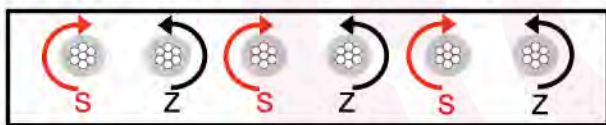

#### 單撚的芯線 Single twist tensile members

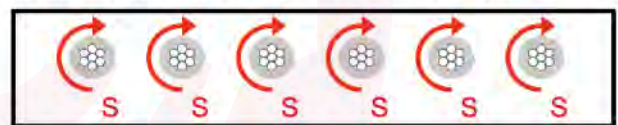

雙撚的芯線自我導引置中  
Self guidance tracking

單撚法的芯線很容易傾向一邊  
Easily leans to one side

自我導引置中降低了皮帶運轉偏行，是由雙撚的張力芯線增加運轉穩定性奠定方向。

The self guidance tracking reduces risk of belts running deviation due to the tension of double twist tensile members increases the running stability and lays the direction.

#### 芯線 Tension Cords

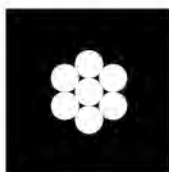

標準  
Standard

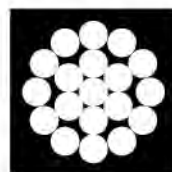

高性能芯線HP  
High Performance

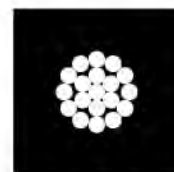

高柔性芯線HF  
High Flexibility

另外，可提供芳綸芯線、不鏽鋼芯線來滿足客戶需求！

In addition, aramid cord and stainless steel cord can be provided to meet customer's needs!



標準型STANDARD

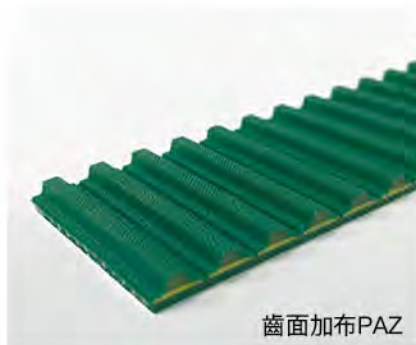

齒面加布PAZ

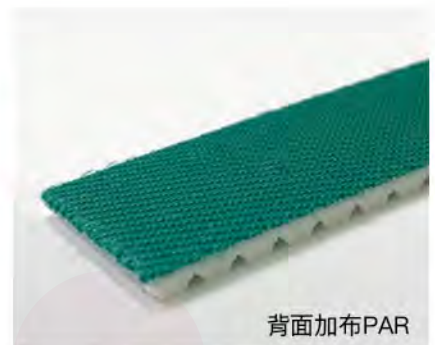

背面加布PAR

型號 Type	節距 Pitch P	齒高 Tooth height hg	帶厚 Belt thickness H
MXL	2.032	0.50	1.55
XL	5.08	1.27	2.30
L	9.525	1.90	3.60
H	12.7	2.30	4.30
XH	22.225	6.35	11.20

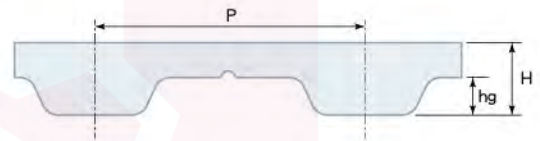

型號 Type	節距 Pitch P	齒高 Tooth height hg	帶厚 Belt thickness H
T2.5	2.5	0.70	1.60
T5	5	1.20	2.20
T10	10	2.50	4.50
T20	20	5.00	8.00



型號 Type	節距 Pitch P	齒高 Tooth height hg	帶厚 Belt thickness H
AT3	3	1.10	1.90
AT5	5	1.20	2.70
AT10	10	2.50	4.50
AT20	20	5.00	8.00

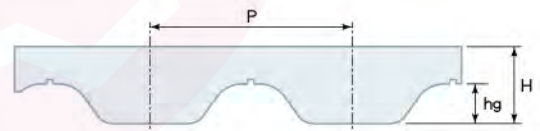

型號 Type	節距 Pitch P	齒高 Tooth height hg	帶厚 Belt thickness H
3M	3	1.20	2.40
5M	5	2.10	3.80
8M	8	3.38	5.60
14M	14	6.00	10.00

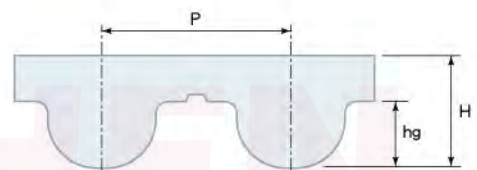

型號 Type	節距 Pitch P	齒高 Tooth height hg	帶厚 Belt thickness H
S5M	5	1.85	3.35
S8M	8	3.05	5.30
S14M	14	5.30	10.20

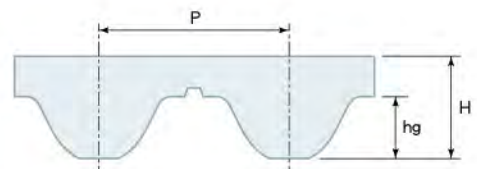

型號 Type	節距 Pitch P	齒高 Tooth height hg	帶厚 Belt thickness H
P5M	5	2.05	3.80
P8M	8	3.20	5.40
P14M	14	6.00	9.70

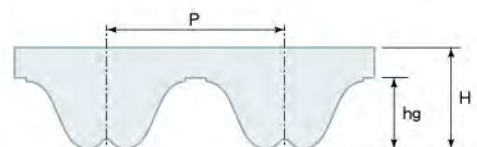



L 開口帶 Open end belt

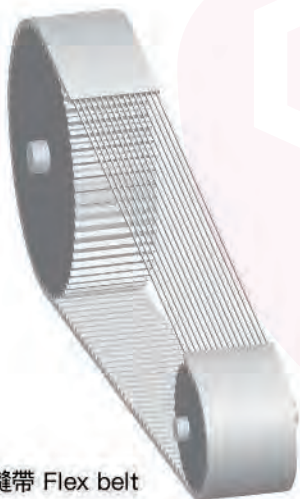

F 無縫帶 Flex belt



J 接合帶 Jointed belt



P 快拆式皮帶 Pin belt

訂購示例 / Order Example

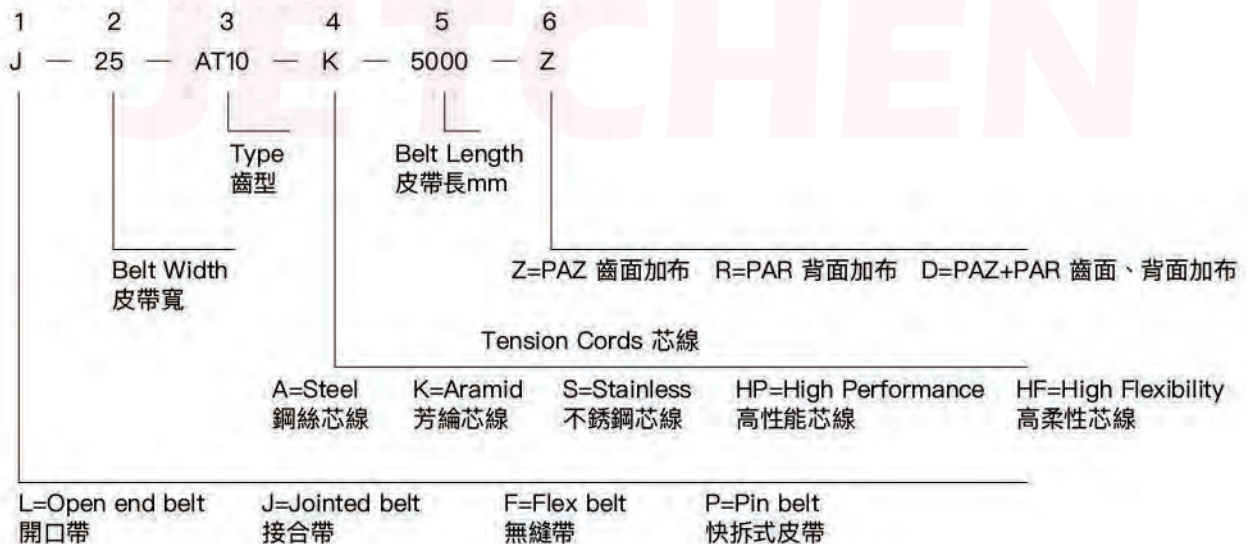

加工皮帶齒面或背面的銑削、背面或側面的打磨、帶齒剔除、皮帶表面打洞和開槽、挖溝，以及對特殊擋塊的表面配置。

不同功能的皮帶背膠加工如PVC、PU、泡綿、尼龍與特殊橡膠。

Processing belt longitudinal milling of the teeth and/or of the back, back and side grinding, teeth removal, belt surface perforation and/or engraving, as well as surface preparation for the application of special profiles.

Differing features belts processed covering materials.

For instance, PVC, PU, foam, nylon cloth and particular rubber.



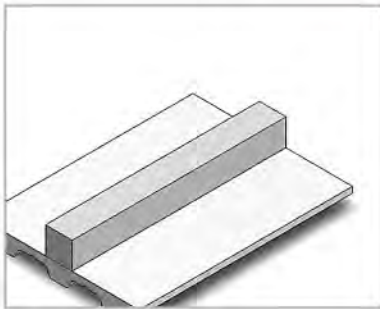

Type A

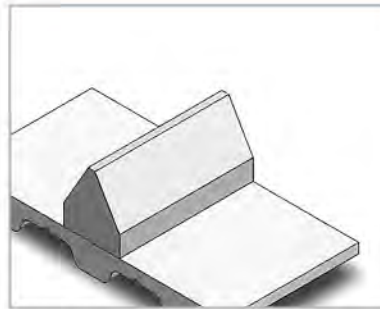

Type B

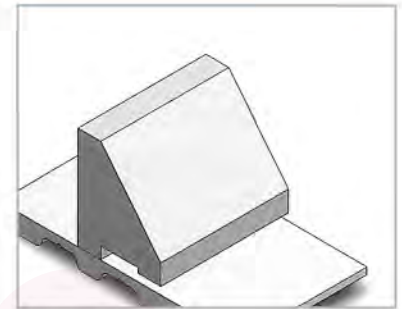

Type C

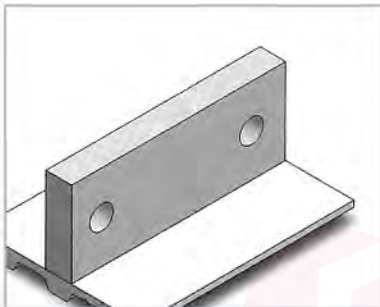

Type D

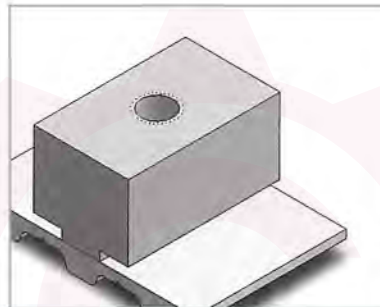

Type E

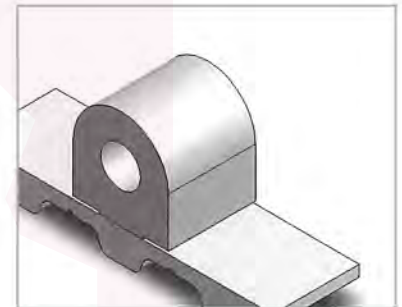

Type F

皮帶型號 Belt type	厚度 Thickness "U" [mm]																							
	2		3		5		6		8		10		12		14		16		20		25		30	
	推薦的最小帶輪齒數 Recommended minimum pulley number of teeth Z																							
	T	M	T	M	T	M	T	M	T	M	T	M	T	M	T	M	T	M	T	M	T	M	T	M
T5	14	20	14	30	20	45	25	50	40	60	60	100	80	-	100	-	-	-	-	-	-	-	-	-
T10	16	20	16	20	16	30	16	40	20	50	25	50	35	60	50	70	80	80	100	100	120	120	-	-
T20	20	20	18	20	18	25	18	40	18	50	20	50	25	50	30	60	40	60	50	60	70	80	-	-
AT5	12	20	12	30	20	45	25	50	40	60	60	100	-	-	100	-	-	-	-	-	-	-	-	-
AT10	18	20	18	20	18	30	18	40	20	50	25	50	35	60	50	70	80	80	100	100	120	120	-	-
AT20	20	20	20	20	20	25	20	40	20	50	20	50	25	50	40	40	50	50	50	60	70	80	100	100
XL	10	20	10	30	20	45	25	50	40	60	50	100	60	100	-	-	-	-	-	-	-	-	-	-
L	12	16	12	20	12	40	20	50	30	60	40	60	50	70	60	80	100	100	-	-	-	-	-	-
H	14	16	14	16	14	25	14	30	20	50	25	50	40	60	50	70	80	80	100	100	120	120	-	-
XH	18	18	18	20	18	20	18	30	18	40	20	50	20	50	25	55	35	60	50	60	70	80	-	-
5M	12	20	12	30	20	45	25	50	40	60	60	100	80	-	100	-	-	-	-	-	-	-	-	-
8M	18	18	18	18	18	24	18	32	18	40	20	40	28	48	40	56	64	64	80	80	100	100	-	-
14M	28	28	28	28	28	28	28	40	28	50	28	50	28	50	30	60	40	50	50	60	100	100	110	110

以下為擋塊形狀示意圖。如果需要，GAINER可根據客戶圖紙提供特製擋板。

The pictures below show samples of cleat shapes. If desired, GAINER can also supply special cleats manufactured according to the customer's drawings.

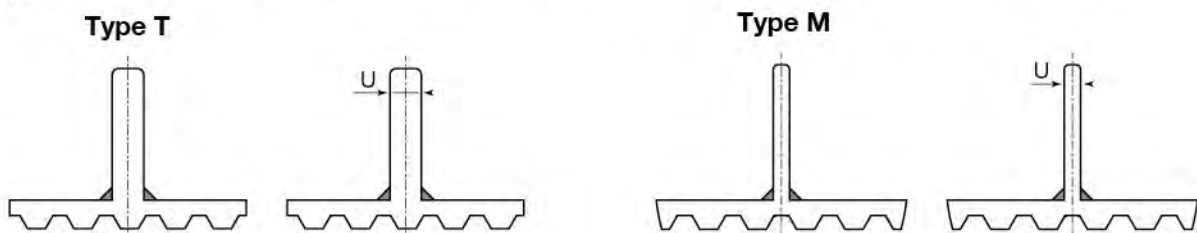



### 產品介紹 PRODUCT INTRODUCTION

GAINER寬幅聚氨酯同步輸送帶具備同步皮帶的優點，更寬大的表面和典型應用的模組化輸送帶。

GAINER Extra-wide Polyurethane Timing Conveyor Belts extend the advantages of synchronous belt to wider surface and typical application of modular conveyor belts.

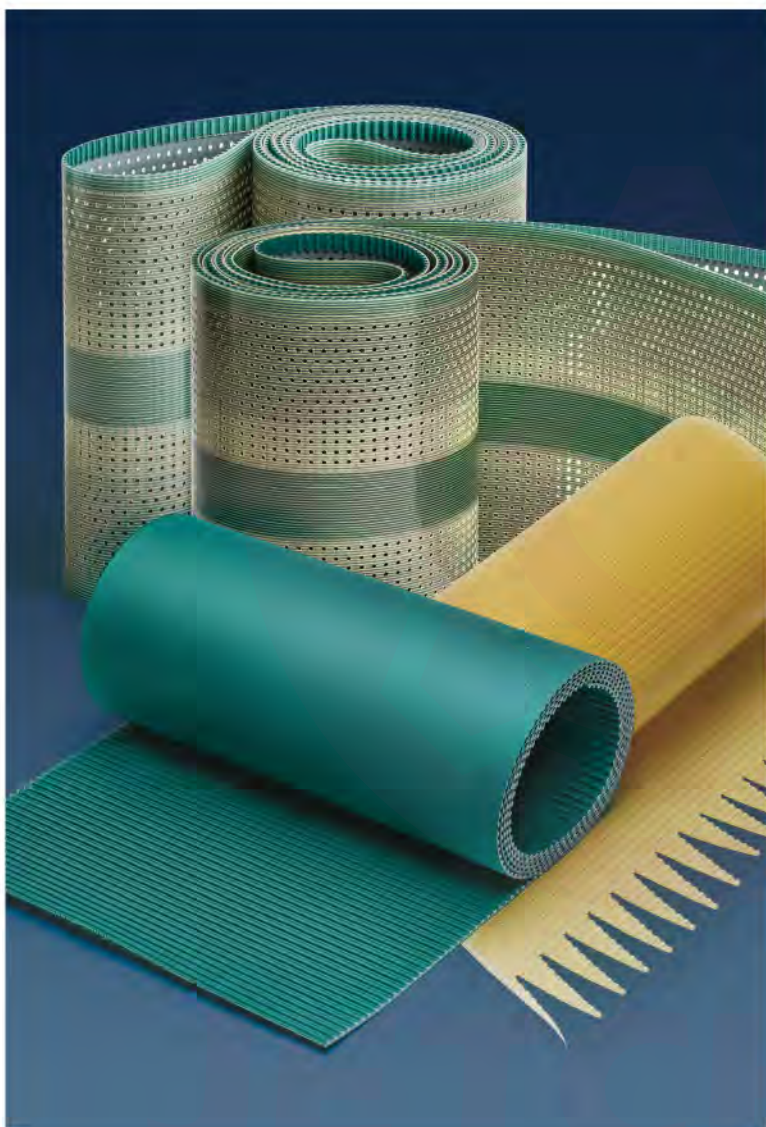

### 產品特點

1. 由特殊PU聚氨酯和增強芳綸線，寬幅帶提供積極的驅動力。
2. 同步輸送沒有偏移滑動，更好的曲撓性，更高的索引/定位精度。
3. 使用更小輪徑限制要求，允許較低的皮帶張力，降低軸承載而節省電力。

### PRODUCT CHARACTERISTICS

1. Made of special PU polyurethane and reinforced Aarmid, Extra-wide belts provides positive driving force.
2. Synchronous conveying without sliding displacement, better flexibility, higher index/position precisely.
3. Smaller pulley diameter restriction requirements, lower belt tension, lower shaft loads and electricity saving.
4. PU composite material is waterproof, anti-adhesive, wear-resistant, resistant to grease and chemicals.

T10	Width (mm)	H	Width (in)
	200		8"
	250		10"
	300		12"
	350		14"
	400		16"
	450		18"
	500		20"

### 產品特點

1. 簡易且快速安裝的PU聚氨酯同步帶。
2. 可使用於正反轉輸送設備上。
3. 可使用於惰輪與背膠加工的同步帶。
4. 保持與同步帶相同的帶輪直徑要求。
5. 可以提供多種齒型的應用設計！
6. 沒有間隙！運轉精準！低噪音！

### PRODUCT CHARACTERISTICS

1. Easy and quick installation.
2. Can be used in forward and reverse conveyor.
3. Can be used in idler pulleys and timing belt with back face machining conveying materials.
4. Keep the same pulley diameter requirements as the timing belt.
5. Provide various tooth type applied design!
6. No gap! Operation precisely! Low noise!



皮帶規格 Belt Type	齒距 (in/mm) Pitch	最小皮帶寬 (in/mm) Minimum Belt Width	最大皮帶寬 (in/mm) Maximum Belt Width
T5	5	10	50
T10	10	16	100
T20	20	25	100
AT5	5	10	50
AT10	10	16	100
AT20	20	25	100
HTD5M	5	10	100
HTD8M	8	15	100
HTD14M	14	40	100
STD5M	5	10	100
STD8M	8	15	100
STD14M	14	40	100
RPP5M	5	10	100
RPP8M	8	15	100
RPP14M	14	40	100
L	3/8" / 9.525	1/2" / 12.7	4" / 101.6
H	1/2" / 12.7	1/2" / 12.7	4" / 101.6

**橡膠 RUBBER**

編碼 GAINER Code	LINATEX	APL	NBR	VITON
材料 Material	天然橡膠 natural rubber	熱塑橡膠 thermoplastic rubber	丁腈橡膠 nitrile rubber	氟化橡膠 viton rubber
顏色 Colour	紅色 red	紅紫色 red purple	黑色/白色/橙色 black/white/orange	黑色 black
硬度 Hardness (°ShA)	40	55	65	75
標準厚度 Standard thickness (mm)	1-10	1-10	1-10	2-4
工作溫度 Working temperature	70°C	60°C	110°C	275°C
耐油性能 Oil resistance	低 low	高 high	高 high	高 high
摩擦係數 Friction coefficient	1.1	0.7	0.7	0.7
耐磨性能 Abrasion resistance	高 high	高 high	高 high	高 high
食品等級 FDA food grade	no	no	no	no
最小輪徑係數 Pulley multiplier CP	15	25	18	30

**聚氨酯/發泡類 POLYURETHANE/CELLULAR**

編碼 GAINER Code	PUR	PUY	SYLOMER	POROL
材料 Material	聚氨酯 polyurethane	聚氨酯 polyurethane	泡棉 elastomeric PUR	泡棉 elastomeric PUR
顏色 Colour	透明 transparent	黃色 yellow	藍色/綠色/棕色 blue/green/brown	黑色 black
硬度 Hardness (°ShA)	70/85	50/70	15	15
標準厚度 Standard thickness (mm)	2-5	2-10	6-25	3-15
工作溫度 Working temperature	70°C	70°C/80°C	70°C	70°C
耐油性能 Oil resistance	高 high	高 high	中 medium	中 medium
摩擦係數 Friction coefficient	0.6	0.8	0.5	0.8
耐磨性能 Abrasion resistance	高 high	高 high	中 medium	中 medium
食品等級 FDA food grade	no	no	no	no
最小輪徑係數 Pulley multiplier CP	25/30	20/25	15	6

最小帶輪直徑=CPx背膠厚度 Min pulley dia=CPxCoating thickness

**橡膠 RUBBER**

編碼 GAINER Code	LINAPLUS	PCF	SIF	SIC
材料 Material	天然橡膠 natural rubber	聚氯乙烯 PVC	矽膠 silicone	矽膠 silicone
顏色 Colour	白色 white	白色 white	藍色 blue	透明 transparent
硬度 Hardness (°ShA)	40	65	30	30
標準厚度 Standard thickness (mm)	1-10	2-3	3-10	3-10
工作溫度 Working temperature	70°C	90°C	220°C	200°C
耐油性能 Oil resistance	低 low	中 medium	高 high	高 high
摩擦係數 Friction coefficient	1.1	1.0	1.1	1.0
耐磨性能 Abrasion resistance	高 high	高 high	高 high	高 high
食品等級 FDA food grade	yes	yes	yes	no
最小輪徑係數 Pulley multiplier CP	15	35	20	20

**聚氨酯/發泡類 POLYURETHANE/CELLULAR**

編碼 GAINER Code	FISHBONE	SUPERGRIP	GROOVE	NON WOVEN
材料 Material	聚氯乙烯 PVC	聚氯乙烯 PVC	聚氯乙烯 PVC	不織布 NON WOVEN
顏色 Colour	白色 white	藍色/綠色 blue / green	綠色 green	灰色 gray
硬度 Hardness (°ShA)	65	60	60	60
標準厚度 Standard thickness (mm)	4	4.5	3.5	2-5
工作溫度 Working temperature	80°C	80°C	80°C	80°C
耐油性能 Oil resistance	高 high	中 medium	高 high	高 high
摩擦係數 Friction coefficient	0.7	0.9	0.9	0.9
耐磨性能 Abrasion resistance	高 high	高 high	高 high	高 high
食品等級 FDA food grade	yes	no	no	no
最小輪徑係數 Pulley multiplier CP	18	12	12	20

最小帶輪直徑=CPx背膠厚度 Min pulley dia=CPxCoating thickness

### 規格 Specification – T2.5

皮帶硬度 Shore hardness 92°A

 寬度公差 Width tolerance  $\pm 0.3\text{mm}$ 

 高度公差 Height tolerance  $\pm 0.15\text{mm}$ 

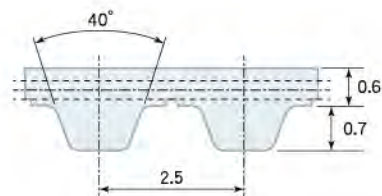
 長度公差 Length tolerance  $\pm 0.5\text{mm/m}$ 

帶寬 Belt width mm	4	6	10	20	50	100
重量 Weight Kg/m	0.004	0.007	0.011	0.022	0.055	0.110

#### 額定負載 Maximum Tensile Strength (N)

帶寬mm Belt width	鋼絲線 Steel Cord $\varnothing 0.3\text{mm}$	
	L	J
4	130	65
6	190	95
10	320	160
20	700	350
50	1860	930
100	3780	1890

#### 斷裂強度 Breaking Strength (N)

帶寬mm Belt width	鋼絲線 Steel Cord $\varnothing 0.3\text{mm}$	
	L	J
4	500	250
6	750	375
10	1250	625
20	2750	1375
50	7250	3625
100	14750	7375

#### 帶齒剪切力 Tooth Strength Load

轉速 rpm	N / cm	轉速 rpm	N / cm	轉速 rpm	N / cm
0	9	500	6	2000	5
20	8	600	6	3000	4
40	8	700	6	4000	4
60	8	800	6	5000	4
80	8	900	5	6000	3
100	8	1000	5	7000	3
200	7	1100	5	8000	3
300	7	1200	5	9000	3
400	6	1500	5	10000	3

帶輪齒數與輪徑最小限制 Minimum pulley number of teeth and minimum idler diameter		鋼絲線 Steel Cord
 無反向彎曲傳動 Drive without reverse bending	同步輪齒數 Minimum pulley number of teeth	15 Z
	帶齒面運轉的張力輪 Tension roller running on teeth	15mm
 有反向彎曲傳動 Drive with reverse bending	同步輪齒數 Minimum pulley number of teeth	18 Z
	皮帶背面上運轉的惰輪 Tension roller running on belt back	18mm

L=Open End 開口帶 J=Jointed 接合帶

**規格 Specification – T5**

皮帶硬度 Shore hardness 92°A

 寬度公差 Width tolerance  $\pm 0.5\text{mm}$ 

 高度公差 Height tolerance  $\pm 0.15\text{mm}$ 

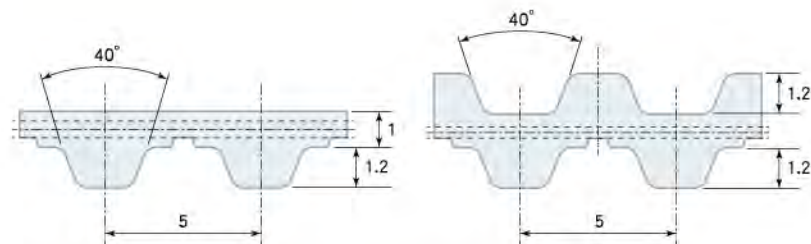
 長度公差 Length tolerance  $\pm 0.5\text{mm/m}$ 

帶寬 Belt width mm	10	16	25	32	50	75	100
重量 Weight Kg/m	0.021	0.034	0.053	0.067	0.105	0.158	0.210

**額定負載 Maximum Tensile Strength (N)**

帶寬mm Belt width	鋼絲線 Steel Cord $\varnothing 0.3\text{mm}$			芳綸線 Aramid Cord $\varnothing 0.3\text{mm}$		
	L	J	F	L	J	F
	10	320	160	320	700	350
16	540	270	540	1190	595	1190
25	900	450	900	1960	980	1960
32	1150	575	1150	2520	1260	2520
50	1860	930	1860	4060	2030	4060
75	2820	1410	2820	6160	3080	6160
100	3780	1890	3780	8260	4130	8260

**斷裂強度 Breaking Strength (N)**

帶寬mm Belt width	鋼絲線 Steel Cord $\varnothing 0.3\text{mm}$			芳綸線 Aramid Cord $\varnothing 0.3\text{mm}$		
	L	J	F	L	J	F
	10	1250	625	1250	2800	1400
16	2125	1062	2125	4760	2380	4760
25	3500	1750	3500	7840	3920	7840
32	4500	2250	4500	10080	5040	10080
50	7250	3625	7250	16240	8120	16240
75	11000	5500	11000	24640	12320	24640
100	14750	7375	14750	33040	16520	33040

**帶齒剪切力 Tooth Strength Load**

轉速 rpm	N / cm	轉速 rpm	N / cm	轉速 rpm	N / cm
0	24	500	18	2000	14
20	24	600	18	3000	13
40	23	700	17	4000	12
60	23	800	17	5000	11
80	22	900	17	6000	10
100	22	1000	16	7000	10
200	20	1100	16	8000	9
300	19	1200	16	9000	9
400	19	1500	15	10000	8

帶輪齒數與輪徑最小限制 Minimum pulley number of teeth and minimum idler diameter	鋼絲線 Steel Cord	芳綸線 Aramid Cord
同步輪齒數 Minimum pulley number of teeth	10 Z	10 Z
無反向彎曲傳動 Drive without reverse bending 帶齒面運轉的張力輪 Tension roller running on teeth	30mm	30mm
有反向彎曲傳動 Drive with reverse bending	15 Z	15 Z
同步輪齒數 Minimum pulley number of teeth 皮帶背面上運轉的惰輪 Tension roller running on belt back	30mm	30mm

L=Open End 開口帶 J=Jointed 接合帶 F=Flex 無縫帶

**規格 Specification – T10**

皮帶硬度 Shore hardness 92°A

寬度公差 Width tolerance ±0.5mm

高度公差 Height tolerance ±0.2mm

長度公差 Length tolerance ±0.5mm/m

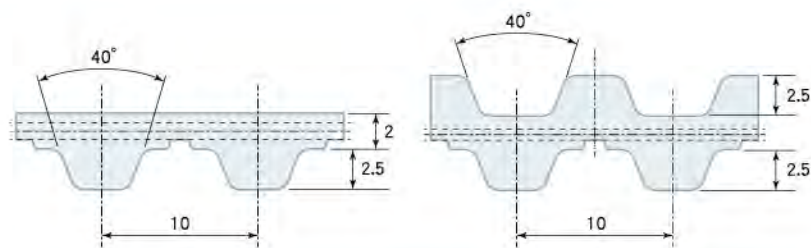

帶寬 Belt width mm	10	16	25	32	50	75	100	150	200
重量 Weight Kg/m	0.05	0.07	0.11	0.15	0.23	0.34	0.45	0.68	0.60

**額定負載 Maximum Tensile Strength (N)**

帶寬mm Belt width	鋼絲線 Steel Cord Ø 0.6mm			芳綸線 Aramid Cord Ø 0.6mm		
	L	J	F	L	J	F
10	920	460	920	880	440	880
16	1610	805	1610	1540	770	1540
25	2650	1325	2650	2530	1265	2530
32	3450	1725	3450	3300	1650	3300
50	5520	2760	5520	5280	2640	5280
75	8400	4200	8400	8030	4015	8030
100	11270	5635	11270	10780	5390	10780
150	17020	8510	17020	16280	8140	16280
200	11270	5635	11270	10780	5390	10780

**斷裂強度 Breaking Strength (N)**

帶寬mm Belt width	鋼絲線 Steel Cord Ø 0.6mm			芳綸線 Aramid Cord Ø 0.6mm		
	L	J	F	L	J	F
10	3360	1680	3360	3600	1800	3600
16	5880	2940	5880	6300	3150	6300
25	9660	4830	9660	10350	5175	10350
32	12600	6300	12600	13500	6750	13500
50	20160	10080	20160	21600	10800	21600
75	30660	15330	30660	32850	16425	32850
100	41160	20580	41160	44100	22050	44100
150	62160	31080	62160	66600	33300	66600
200	41160	20580	41160	44100	22050	44100

**帶齒剪切力 Tooth Strength Load**

轉速 rpm	N / cm	轉速 rpm	N / cm	轉速 rpm	N / cm
0	51	500	36	2000	26
20	50	600	35	3000	23
40	49	700	34	4000	20
60	48	800	33	5000	18
80	47	900	32	6000	17
100	46	1000	32	7000	16
200	43	1100	30	8000	15
300	40	1200	30	9000	14
400	38	1500	28	10000	13

**帶輪齒數與輪徑最小限制**

Minimum pulley number of teeth and minimum idler diameter

鋼絲線

Steel Cord

芳綸線

Aramid Cord

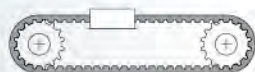
 無反向彎曲傳動  
 Drive without reverse bending

 同步輪齒數  
 Minimum pulley number of teeth

 帶齒面運轉的張力輪  
 Tension roller running on teeth

12 Z

15 Z

60mm

60mm

 有反向彎曲傳動  
 Drive with reverse bending

 同步輪齒數  
 Minimum pulley number of teeth

 帶帶背面上運轉的惰輪  
 Tension roller running on belt back

20 Z

20 Z

60mm

60mm

L=Open End 開口帶 J=Jointed 接合帶 F=Flex 無縫帶

## 規格 Specification – T20

皮帶硬度 Shore hardness 92°A  
寬度公差 Width tolerance ±1.0mm  
高度公差 Height tolerance ±0.4mm  
長度公差 Length tolerance ±0.5mm/m

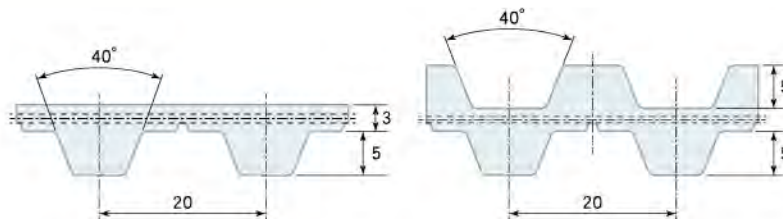

帶寬 Belt width mm	25	32	50	75	100	150
重量 Weight Kg/m	0.20	0.26	0.41	0.61	0.82	1.23

### 額定負載 Maximum Tensile Strength (N)

帶寬mm Belt width	鋼絲線 Steel Cord Ø 0.9mm			芳綸線 Aramid Cord Ø 1.2mm		
	L	J	F	L	J	F
25	4170	2085	4170	3740	1870	3740
32	5390	2695	5390	4840	2420	4840
50	8580	4290	8580	7700	3850	7700
75	12990	6495	12990	11660	5830	11660
100	17400	8700	17400	15620	7810	15620
150	26220	13110	26220	23540	11770	23540

### 斷裂強度 Breaking Strength (N)

帶寬mm Belt width	鋼絲線 Steel Cord Ø 0.9mm			芳綸線 Aramid Cord Ø 1.2mm		
	L	J	F	L	J	F
25	16150	8075	16150	17000	8500	17000
32	20900	10450	20900	22000	11000	22000
50	33250	16625	33250	35000	17500	35000
75	50350	25175	50350	53000	26500	53000
100	67450	33725	67450	71000	35500	71000
150	101650	50825	101650	107000	53500	107000

### 帶齒剪切力 Tooth Strength Load

轉速 rpm	N / cm	轉速 rpm	N / cm	轉速 rpm	N / cm
0	104	500	69	1600	50
20	101	600	66	1700	49
40	98	700	64	1800	47
60	95	800	62	2000	45
80	93	900	60	3000	38
100	91	1000	58	4000	33
200	83	1100	56	5000	28
300	77	1200	55	6000	25
400	73	1500	51	6500	24

帶輪齒數與輪徑最小限制 Minimum pulley number of teeth and minimum idler diameter	鋼絲線 Steel Cord	芳綸線 Aramid Cord
無反向彎曲傳動 Drive without reverse bending	同步輪齒數 Minimum pulley number of teeth 15 Z	15 Z
有反向彎曲傳動 Drive with reverse bending	帶齒面運轉的張力輪 Tension roller running on teeth 120mm	120mm
有反向彎曲傳動 Drive with reverse bending	帶齒面運轉的惰輪 Tension roller running on belt back 120mm	120mm

L=Open End 開口帶 J=Jointed 接合帶 F=Flex 無縫帶



### 規格 Specification – AT3

皮帶硬度 Shore hardness 92°A  
 寬度公差 Width tolerance±0.5mm  
 高度公差 Height tolerance±0.2mm  
 長度公差 Length tolerance±0.5mm/m

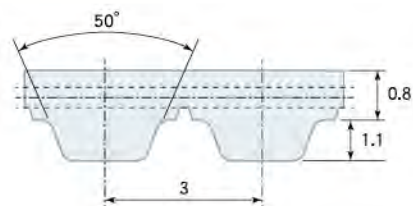

帶寬 Belt width mm	8	10	12	16	20	25
重量 Weight Kg/m	0.018	0.022	0.026	0.035	0.044	0.054

#### 額定負載 Maximum Tensile Strength (N)

帶寬mm Belt width	鋼絲線 Steel Cord Ø 0.3mm	
	L	J
8	260	130
10	320	160
12	416	208
16	540	270
20	700	350
25	900	450

#### 斷裂強度 Breaking Strength (N)

帶寬mm Belt width	鋼絲線 Steel Cord Ø 0.3mm	
	L	J
8	1000	500
10	1250	625
12	1625	812
16	2125	1062
20	2750	1375
25	3500	1750

#### 帶齒剪切力 Tooth Strength Load

轉速 rpm	N / cm	轉速 rpm	N / cm	轉速 rpm	N / cm
0	32	500	28	2000	20
20	32	600	27	3000	18
40	31	700	26	4000	16
60	31	800	25	5000	14
80	31	900	25	6000	13
100	30	1000	24	7000	12
200	29	1100	24	8000	11
300	29	1200	23	9000	11
400	28	1500	22	10000	10

帶輪齒數與輪徑最小限制 Minimum pulley number of teeth and minimum idler diameter		鋼絲線 Steel Cord
 無反向彎曲傳動 Drive without reverse bending	同步輪齒數 Minimum pulley number of teeth	15 Z
	帶齒面運轉的張力輪 Tension roller running on teeth	20mm
 有反向彎曲傳動 Drive with reverse bending	同步輪齒數 Minimum pulley number of teeth	20 Z
	皮帶背面上運轉的惰輪 Tension roller running on belt back	20mm

L=Open End 開口帶 J=Jointed 接合帶

**規格 Specification – AT5**

皮帶硬度 Shore hardness 92°A  
 寬度公差 Width tolerance  $\pm 0.5\text{mm}$   
 高度公差 Height tolerance  $\pm 0.2\text{mm}$   
 長度公差 Length tolerance  $\pm 0.5\text{mm/m}$

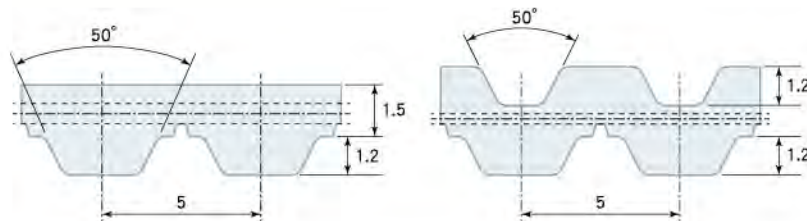

帶寬 Belt width mm	10	16	25	32	50	75	100
重量 Weight Kg/m	0.03	0.05	0.09	0.11	0.17	0.26	0.34

**額定負載 Maximum Tensile Strength (N)**

帶寬mm Belt width	鋼絲線 Steel Cord $\varnothing 0.5\text{mm}$			芳綸線 Aramid Cord $\varnothing 0.6\text{mm}$		
	L	J	F	L	J	F
10	640	320	640	880	440	880
16	1120	560	1120	1540	770	1540
25	1840	920	1840	2530	1265	2530
32	2400	1200	2400	3300	1650	3300
50	3840	1920	3840	5280	2640	5280
75	5840	2920	5840	8030	4015	8030
100	7840	3920	7840	10780	5390	10780

**斷裂強度 Breaking Strength (N)**

帶寬mm Belt width	鋼絲線 Steel Cord $\varnothing 0.5\text{mm}$			芳綸線 Aramid Cord $\varnothing 0.6\text{mm}$		
	L	J	F	L	J	F
10	2160	1080	2160	3600	1800	3600
16	3780	1890	3780	6300	3150	6300
25	6210	3105	6210	10350	5175	10350
32	8100	4050	8100	13500	6750	13500
50	12960	6480	12960	21600	10800	21600
75	19710	9855	19710	32850	16425	32850
100	26460	13230	26460	44100	22050	44100

**帶齒剪切力 Tooth Strength Load**

轉速 rpm	N / cm	轉速 rpm	N / cm	轉速 rpm	N / cm
0	36	500	29	2000	22
20	35	600	29	3000	19
40	35	700	28	4000	17
60	34	800	27	5000	16
80	34	900	27	6000	15
100	34	1000	26	7000	14
200	32	1100	25	8000	13
300	31	1200	25	9000	12
400	30	1500	24	10000	11

帶輪齒數與輪徑最小限制 Minimum pulley number of teeth and minimum idler diameter	鋼絲線 Steel Cord	芳綸線 Aramid Cord
 無反向彎曲傳動 Drive without reverse bending	同步輪齒數 Minimum pulley number of teeth 15 Z	15 Z
 帶齒面運轉的張力輪 Tension roller running on teeth 30mm	30mm	30mm
 有反向彎曲傳動 Drive with reverse bending	同步輪齒數 Minimum pulley number of teeth 25 Z	25 Z
 皮帶背面上運轉的惰輪 Tension roller running on belt back 60mm	60mm	60mm

L=Open End 開口帶 J=Jointed 接合帶 F=Flex 無縫帶

**規格 Specification – AT5L**

皮帶硬度 Shore hardness 92°A  
 寬度公差 Width tolerance  $\pm 0.5\text{mm}$   
 高度公差 Height tolerance  $\pm 0.2\text{mm}$   
 長度公差 Length tolerance  $\pm 0.5\text{mm/m}$

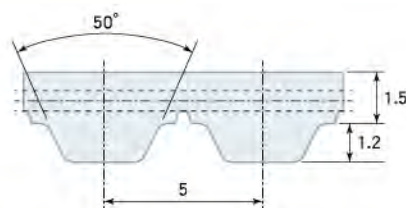

帶寬 Belt width mm	10	16	25	32	50	75	100
重量 Weight Kg/m	0.04	0.06	0.10	0.12	0.19	0.29	0.38

**額定負載 Maximum Tensile Strength (N)**

帶寬mm Belt width	HP鋼絲線 Steel Cord $\varnothing 0.6\text{mm}$		
	L	J	F
10	920	460	920
16	1610	805	1610
25	2650	1325	2650
32	3450	1725	3450
50	5520	2760	5520
75	8400	4200	8400
100	11270	5635	11270

**斷裂強度 Breaking Strength (N)**

帶寬mm Belt width	HP鋼絲線 Steel Cord $\varnothing 0.6\text{mm}$		
	L	J	F
10	3360	1680	3360
16	5880	2940	5880
25	9660	4830	9660
32	12600	6300	12600
50	20160	10080	20160
75	30660	15330	30660
100	41160	20580	41160

**帶齒剪切力 Tooth Strength Load**

轉速 rpm	N / cm	轉速 rpm	N / cm	轉速 rpm	N / cm
0	36	500	29	2000	22
20	35	600	29	3000	19
40	35	700	28	4000	17
60	34	800	27	5000	16
80	34	900	27	6000	15
100	34	1000	26	7000	14
200	32	1100	25	8000	13
300	31	1200	25	9000	12
400	30	1500	24	10000	11

帶輪齒數與輪徑最小限制 Minimum pulley number of teeth and minimum idler diameter		鋼絲線 Steel Cord
 無反向彎曲傳動 Drive without reverse bending	同步輪齒數 Minimum pulley number of teeth	25 Z
	帶齒面運轉的張力輪 Tension roller running on teeth	40mm
 有反向彎曲傳動 Drive with reverse bending	同步輪齒數 Minimum pulley number of teeth	25 Z
	皮帶背面上運轉的惰輪 Tension roller running on belt back	60mm

L=Open End 開口帶 J=Jointed 接合帶 F=Flex 無縫帶

**規格 Specification – AT10**

皮帶硬度 Shore hardness 92°A  
 寬度公差 Width tolerance±0.5mm  
 高度公差 Height tolerance±0.2mm  
 長度公差 Length tolerance±0.5mm/m

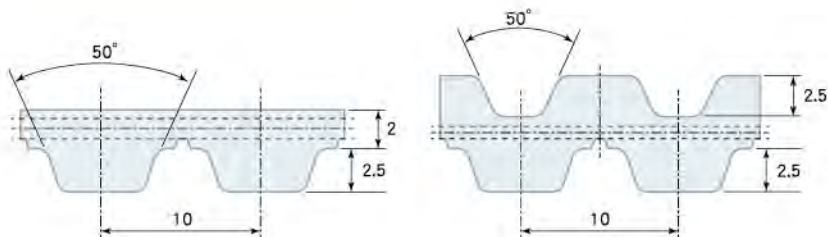

帶寬 Belt width mm	16	25	32	50	75	100	150
重量 Weight Kg/m	0.09	0.15	0.19	0.30	0.44	0.59	0.90

**額定負載 Maximum Tensile Strength (N)**

帶寬mm Belt width	鋼絲線 Steel Cord Ø 0.9mm			芳綸線 Aramid Cord Ø 1.2mm		
	L	J	F	L	J	F
16	2450	1225	2450	2200	1100	2200
25	4170	2085	4170	3740	1870	3740
32	5390	2695	5390	4840	2420	4840
50	8580	4290	8580	7700	3850	7700
75	12990	6495	12990	11660	5830	11660
100	17400	8700	17400	15620	7810	15620
150	26220	13110	26220	23540	11770	23540

**斷裂強度 Breaking Strength (N)**

帶寬mm Belt width	鋼絲線 Steel Cord Ø 0.9mm			芳綸線 Aramid Cord Ø 1.2mm		
	L	J	F	L	J	F
16	9500	4750	9500	10000	5000	10000
25	16150	8075	16150	17000	8500	17000
32	20900	10450	20900	22000	11000	22000
50	33250	16625	33250	35000	17500	35000
75	50350	25175	50350	53000	26500	53000
100	67450	33725	67450	71000	35500	71000
150	101650	50825	101650	107000	53500	107000

**帶齒剪切力 Tooth Strength Load**

轉速 rpm	N / cm	轉速 rpm	N / cm	轉速 rpm	N / cm
0	88	500	69	2000	48
20	87	600	66	3000	41
40	85	700	64	4000	36
60	84	800	62	5000	32
80	83	900	61	6000	28
100	81	1000	59	7000	26
200	77	1100	58	8000	23
300	75	1200	56	9000	21
400	71	1500	53	10000	19

**帶輪齒數與輪徑最小限制**

Minimum pulley number of teeth and minimum idler diameter

鋼絲線

Steel Cord

芳綸線

Aramid Cord

 無反向彎曲傳動  
 Drive without reverse bending

 同步輪齒數  
 Minimum pulley number of teeth

 帶齒面運轉的張力輪  
 Tension roller running on teeth

15 Z

15 Z

50mm

50mm

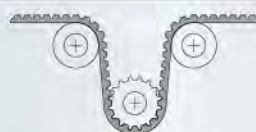
 有反向彎曲傳動  
 Drive with reverse bending

 同步輪齒數  
 Minimum pulley number of teeth

 皮帶背面上運轉的惰輪  
 Tension roller running on belt back

25 Z

20 Z

120mm

120mm

L=Open End 開口帶 J=Jointed 接合帶 F=Flex 無縫帶

**規格 Specification – AT10L**

皮帶硬度 Shore hardness 92°A  
 寬度公差 Width tolerance±0.5mm  
 高度公差 Height tolerance±0.2mm  
 長度公差 Length tolerance±0.5mm/m

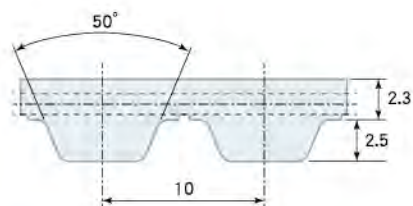

帶寬 Belt width mm	16	25	32	50	75	100	150
重量 Weight Kg/m	0.11	0.17	0.22	0.35	0.52	0.69	0.85

**額定負載 Maximum Tensile Strength (N)**

帶寬mm Belt width	HP鋼絲線 Steel Cord Ø 1.2mm		
	L	J	F
16	3840	1920	3840
25	6720	3360	6720
32	8640	4320	8640
50	14400	7200	14400
75	21600	10800	21600
100	29280	14640	29280
150	44160	22080	44160

**斷裂強度 Breaking Strength (N)**

帶寬mm Belt width	HP鋼絲線 Steel Cord Ø 1.2mm		
	L	J	F
16	14000	7000	14000
25	24500	12250	24500
32	31500	15750	31500
50	52500	26250	52500
75	78750	39375	78750
100	106750	53375	106750
150	161000	80500	161000

**帶齒剪切力 Tooth Strength Load**

轉速 rpm	N / cm	轉速 rpm	N / cm	轉速 rpm	N / cm
0	88	500	69	2000	48
20	87	600	66	3000	41
40	85	700	64	4000	36
60	84	800	62	5000	32
80	83	900	61	6000	28
100	81	1000	59	7000	26
200	77	1100	58	8000	23
300	75	1200	56	9000	21
400	71	1500	53	10000	19

**帶輪齒數與輪徑最小限制**

Minimum pulley number of teeth and minimum idler diameter

 鋼絲線  
Steel Cord

 無反向彎曲傳動  
Drive without reverse bending

 同步輪齒數  
Minimum pulley number of teeth

25 Z

 帶齒面運轉的張力輪  
Tension roller running on teeth

80mm

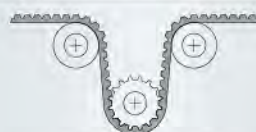
 有反向彎曲傳動  
Drive with reverse bending

 同步輪齒數  
Minimum pulley number of teeth

25 Z

 皮帶背面上運轉的惰輪  
Tension roller running on belt back

150mm

L=Open End 開口帶 J=Jointed 接合帶 F=Flex 無縫帶

**規格 Specification – AT20**

皮帶硬度 Shore hardness 92°A  
 寬度公差 Width tolerance  $\pm 1.0\text{mm}$   
 高度公差 Height tolerance  $\pm 0.4\text{mm}$   
 長度公差 Length tolerance  $\pm 0.5\text{mm/m}$

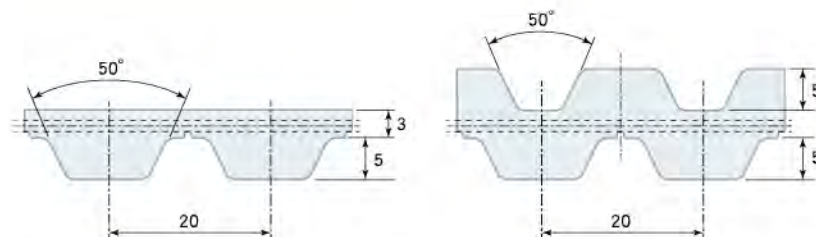

帶寬 Belt width mm	25	32	50	75	100	150
重量 Weight Kg/m	0.24	0.31	0.48	0.73	0.97	1.45

**額定負載 Maximum Tensile Strength (N)**

帶寬mm Belt width	鋼絲線 Steel Cord $\varnothing 1.2\text{mm}$			芳綸線 Aramid Cord $\varnothing 1.2\text{mm}$		
	L	J	F	L	J	F
25	5280	2640	5280	2420	1210	2420
32	7200	3600	7200	3300	1650	3300
50	11520	5760	11520	5280	2640	5280
75	17280	8640	17280	7920	3960	7920
100	23520	11760	23520	10780	5390	10780
150	35520	17760	35520	-	-	-

**斷裂強度 Breaking Strength (N)**

帶寬mm Belt width	鋼絲線 Steel Cord $\varnothing 1.2\text{mm}$			芳綸線 Aramid Cord $\varnothing 1.2\text{mm}$		
	L	J	F	L	J	F
25	19250	9625	19250	11000	5500	11000
32	26250	13125	26250	15000	7500	15000
50	42000	21000	42000	24000	12000	24000
75	63000	31500	63000	36000	18000	36000
100	85750	42875	85750	49000	24500	49000
150	129500	64750	129500	-	-	-

**帶齒剪切力 Tooth Strength Load**

轉速 rpm	N / cm	轉速 rpm	N / cm	轉速 rpm	N / cm
0	151	500	110	1600	75
20	148	600	105	1700	73
40	145	700	101	1800	71
60	143	800	97	2000	68
80	141	900	93	3000	54
100	138	1000	90	4000	43
200	129	1100	87	5000	35
300	122	1200	85	6000	29
400	115	1500	77	6500	26

**帶齒齒數與輪徑最小限制**

Minimum pulley number of teeth and minimum idler diameter

鋼絲線

Steel Cord

芳綸線

Aramid Cord



 無反向彎曲傳動  
 Drive without reverse bending

 同步輪齒數  
 Minimum pulley number of teeth

18 Z      18 Z

 帶齒面運轉的張力輪  
 Tension roller running on teeth

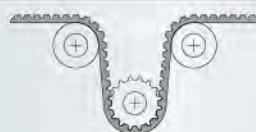
120mm      120mm

 有反向彎曲傳動  
 Drive with reverse bending

 同步輪齒數  
 Minimum pulley number of teeth

25 Z      25 Z

 皮帶背面上運轉的惰輪  
 Tension roller running on belt back

180mm      160mm

L=Open End 開口帶    J=Jointed 接合帶    F=Flex 無縫帶

**規格 Specification – AT20L**

皮帶硬度 Shore hardness 92°A  
 寬度公差 Width tolerance  $\pm 1.0\text{mm}$   
 高度公差 Height tolerance  $\pm 0.4\text{mm}$   
 長度公差 Length tolerance  $\pm 0.4\text{mm/m}$

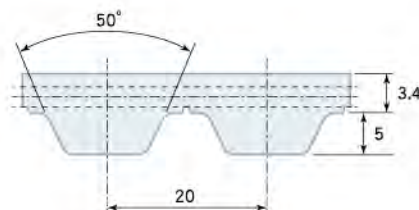

帶寬 Belt width mm	25	32	50	75	100	150	200
重量 Weight Kg/m	0.28	0.36	0.56	0.84	1.12	1.68	2.25

**額定負載 Maximum Tensile Strength (N)**

帶寬mm Belt width	HP鋼絲線 Steel Cord $\varnothing 1.6\text{mm}$		
	L	J	F
25	7650	3825	7650
32	10200	5100	10200
50	16150	8075	16150
75	24650	12325	24650
100	33150	16575	33150
150	51000	25500	51000
200	68000	34000	68000

**斷裂強度 Breaking Strength (N)**

帶寬mm Belt width	HP鋼絲線 Steel Cord $\varnothing 1.6\text{mm}$		
	L	J	F
25	28800	14400	28800
32	38400	19200	38400
50	60800	30400	60800
75	92800	46400	92800
100	124800	62400	124800
150	192000	96000	192000
200	256000	128000	256000

**帶齒剪切力 Tooth Strength Load**

轉速 rpm	N / cm	轉速 rpm	N / cm	轉速 rpm	N / cm
0	151	500	110	1600	75
20	148	600	105	1700	73
40	145	700	101	1800	71
60	143	800	97	2000	68
80	141	900	93	3000	54
100	138	1000	90	4000	43
200	129	1100	87	5000	35
300	122	1200	85	6000	29
400	115	1500	77	6500	26

**帶輪齒數與輪徑最小限制**

Minimum pulley number of teeth and minimum idler diameter

 鋼絲線  
Steel Cord

 無反向彎曲傳動  
Drive without reverse bending

 同步輪齒數  
Minimum pulley number of teeth

25 Z

 帶齒面運轉的張力輪  
Tension roller running on teeth

160mm

 有反向彎曲傳動  
Drive with reverse bending

 同步輪齒數  
Minimum pulley number of teeth

25 Z

 皮帶背面上運轉的惰輪  
Tension roller running on belt back

250mm

L=Open End 開口帶 J=Jointed 接合帶 F=Flex 無縫帶

**規格 Specification – MXL**

皮帶硬度 Shore hardness 92°A  
 寬度公差 Width tolerance±0.5mm  
 高度公差 Height tolerance±0.1mm  
 長度公差 Length tolerance±0.8mm/m

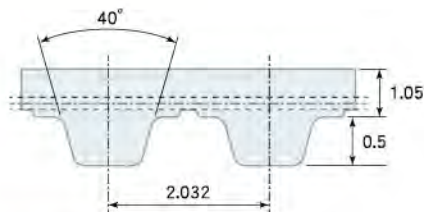

帶寬 Belt width mm	025/6.35	050/12.7	100/25.4	200/50.8	400/101.6
重量 Weight Kg/m	0.014	0.025	0.050	0.095	0.190

**額定負載 Maximum Tensile Strength (N)**

帶寬mm Belt width	鋼絲線 Steel Cord Ø 0.25mm	
	L	J
025/6.35	220	110
050/12.7	450	225
100/25.4	900	450
200/50.8	1790	895
400/101.6	3580	1790

**斷裂強度 Breaking Strength (N)**

帶寬mm Belt width	鋼絲線 Steel Cord Ø 0.25mm	
	L	J
025/6.35	875	437
050/12.7	1750	875
100/25.4	3500	1750
200/50.8	7000	3500
400/101.6	14000	7000

**帶齒剪切力 Tooth Strength Load**

轉速 rpm	N / cm	轉速 rpm	N / cm	轉速 rpm	N / cm
0	7	500	5	2000	4
20	7	600	5	3000	3
40	7	700	5	4000	3
60	6	800	4	5000	3
80	6	900	4	6000	3
100	6	1000	4	7000	3
200	6	1100	4	8000	3
300	5	1200	4	9000	2
400	5	1500	4	10000	2

**帶輪齒數與輪徑最小限制**

Minimum pulley number of teeth and minimum idler diameter

 鋼絲線  
 Steel Cord

 無反向彎曲傳動  
 Drive without reverse bending

 同步輪齒數  
 Minimum pulley number of teeth

12 Z

 帶齒面運轉的張力輪  
 Tension roller running on teeth

20mm

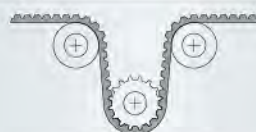
 有反向彎曲傳動  
 Drive with reverse bending

 同步輪齒數  
 Minimum pulley number of teeth

15 Z

 皮帶背面上運轉的惰輪  
 Tension roller running on belt back

25mm

L=Open End 開口帶 J=Jointed 接合帶



### 規格 Specification – XL

皮帶硬度 Shore hardness 92°A  
 寬度公差 Width tolerance ±0.5mm  
 高度公差 Height tolerance ±0.2mm  
 長度公差 Length tolerance ±0.5mm/m

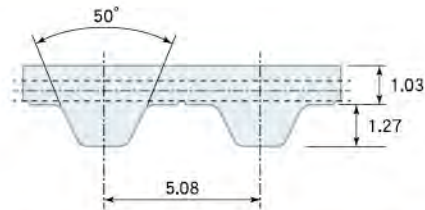

帶寬 Belt width mm	025/6.35	037/9.53	050/12.7	075/19.1	100/25.4	150/38.1	200/50.8	400/101.6
重量 Weight Kg/m	0.015	0.023	0.031	0.046	0.061	0.092	0.122	0.244

#### 額定負載 Maximum Tensile Strength (N)

帶寬mm Belt width	鋼絲線 Steel Cord Ø 0.3mm			芳綸線 Aramid Cord Ø 0.3mm		
	L	J	F	L	J	F
025/6.35	190	95	190	420	210	420
037/9.53	290	145	290	630	315	630
050/12.7	420	210	420	910	455	910
075/19.1	670	335	670	1470	735	1470
100/25.4	900	450	900	1960	980	1960
150/38.1	1410	705	1410	3080	1540	3080
200/50.8	1890	945	1890	4130	2065	4130
400/101.6	3840	1920	3840	8400	4200	8400

#### 斷裂強度 Breaking Strength (N)

帶寬mm Belt width	鋼絲線 Steel Cord Ø 0.3mm			芳綸線 Aramid Cord Ø 0.3mm		
	L	J	F	L	J	F
025/6.35	750	375	750	1680	840	1680
037/9.53	1125	562	1125	2520	1260	2520
050/12.7	1625	812	1625	3640	1820	3640
075/19.1	2625	1312	2625	5880	2940	5880
100/25.4	3500	1750	3500	7840	3920	7840
150/38.1	5500	2750	5500	12320	6160	12320
200/50.8	7375	3687	7375	16520	8260	16520
400/101.6	15000	7500	15000	33600	16800	33600

#### 帶齒剪切力 Tooth Strength Load

轉速 rpm	N / cm	轉速 rpm	N / cm	轉速 rpm	N / cm
0	25	500	18	2000	14
20	24	600	18	3000	13
40	23	700	17	4000	11
60	23	800	17	5000	11
80	23	900	16	6000	10
100	22	1000	16	7000	9
200	21	1100	16	8000	9
300	20	1200	16	9000	8
400	19	1500	15	10000	8

#### 帶輪齒數與輪徑最小限制

Minimum pulley number of teeth and minimum idler diameter

鋼絲線

Steel Cord

芳綸線

Aramid Cord



無反向彎曲傳動  
Drive without reverse bending

同步輪齒數  
Minimum pulley number of teeth

10 Z

10 Z

帶齒面運轉的張力輪  
Tension roller running on teeth

30mm

30mm

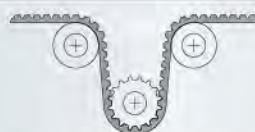

有反向彎曲傳動  
Drive with reverse bending

同步輪齒數  
Minimum pulley number of teeth

15 Z

15 Z

皮帶背面上運轉的惰輪  
Tension roller running on belt back

30mm

30mm

L=Open End 開口帶 J=Jointed 接合帶 F=Flex 無縫帶

## 規格 Specification – L

皮帶硬度 Shore hardness 92°A  
 寬度公差 Width tolerance ±0.5mm  
 高度公差 Height tolerance ±0.2mm  
 長度公差 Length tolerance ±0.5mm/m

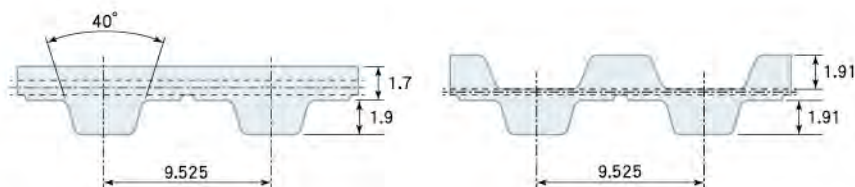

帶寬 Belt width mm	050/12.7	075/19.1	100/25.4	150/38.1	200/50.8	300/76.2	400/101.6
重量 Weight Kg/m	0.049	0.073	0.098	0.146	0.195	0.293	0.390

## 額定負載 Maximum Tensile Strength (N)

帶寬mm Belt width	鋼絲線 Steel Cord Ø 0.5mm			芳綸線 Aramid Cord Ø 0.6mm		
	L	J	F	L	J	F
050/12.7	1270	635	1270	1210	605	1210
075/19.1	1960	980	1960	1870	935	1870
100/25.4	2760	1380	2760	2640	1320	2640
150/38.1	4260	2130	4260	4070	2035	4070
200/50.8	5640	2820	5640	5390	2695	5390
300/76.2	8510	4255	8510	8140	4070	8140
400/101.6	11390	5695	11390	10890	5445	10890

## 斷裂強度 Breaking Strength (N)

帶寬mm Belt width	鋼絲線 Steel Cord Ø 0.5mm			芳綸線 Aramid Cord Ø 0.6mm		
	L	J	F	L	J	F
050/12.7	4620	2310	4620	4950	2475	4950
075/19.1	7140	3570	7140	7650	3825	7650
100/25.4	10080	5040	10080	10800	5400	10800
150/38.1	15540	7770	15540	16650	8325	16650
200/50.8	20580	10290	20580	22050	11025	22050
300/76.2	31080	15540	31080	33300	16650	33300
400/101.6	41580	20790	41580	44550	22275	44550

## 帶齒剪切力 Tooth Strength Load

轉速 rpm	N / cm	轉速 rpm	N / cm	轉速 rpm	N / cm
0	38	500	27	2000	19
20	37	600	26	3000	16
40	36	700	25	4000	15
60	35	800	24	5000	13
80	34	900	24	6000	12
100	34	1000	23	7000	11
200	31	1100	22	8000	10
300	29	1200	22	9000	10
400	28	1500	21	10000	9

## 帶輪齒數與輪徑最小限制

Minimum pulley number of teeth and minimum idler diameter

鋼絲線

Steel Cord

芳綸線

Aramid Cord

 無反向彎曲傳動  
 Drive without reverse bending

 同步輪齒數  
 Minimum pulley number of teeth

15 Z

15 Z

 帶齒面運轉的張力輪  
 Tension roller running on teeth

60mm

60mm

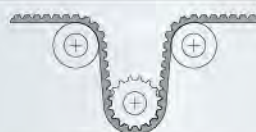
 有反向彎曲傳動  
 Drive with reverse bending

 同步輪齒數  
 Minimum pulley number of teeth

20 Z

20 Z

 皮帶背面上運轉的惰輪  
 Tension roller running on belt back

60mm

60mm

L=Open End 開口帶 J=Jointed 接合帶 F=Flex 無縫帶

**規格 Specification – H**

皮帶硬度 Shore hardness 92°A

寬度公差 Width tolerance ±0.5mm

高度公差 Height tolerance ±0.2mm

長度公差 Length tolerance ±0.5mm/m

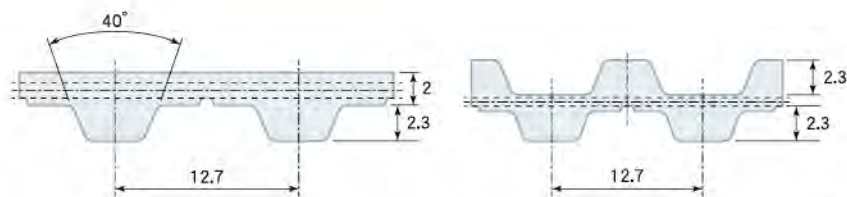

帶寬 Belt width mm	050/12.7	075/19.1	100/25.4	150/38.1	200/50.8	300/76.2	400/101.6	600/152.4	800/203.2
重量 Weight Kg/m	0.05	0.08	0.11	0.16	0.22	0.32	0.43	0.56	0.65

**額定負載 Maximum Tensile Strength (N)**

帶寬mm Belt width	鋼絲線 Steel Cord Ø 0.6mm			芳綸線 Aramid Cord Ø 0.6mm		
	L	J	F	L	J	F
050/12.7	1270	635	1270	1210	605	1210
075/19.1	1960	980	1960	1870	935	1870
100/25.4	2760	1380	2760	2640	1320	2640
150/38.1	4260	2130	4260	4070	2035	4070
200/50.8	5640	2820	5640	5390	2695	5390
300/76.2	8510	4255	8510	8140	4070	8140
400/101.6	11390	5695	11390	10890	5445	10890
600/152.4	17250	8625	17250	16500	8250	16500
800/203.2	11390	5695	11390	10890	5445	10890

**斷裂強度 Breaking Strength (N)**

帶寬mm Belt width	鋼絲線 Steel Cord Ø 0.6mm			芳綸線 Aramid Cord Ø 0.6mm		
	L	J	F	L	J	F
050/12.7	4620	2310	4620	4950	2475	4950
075/19.1	7140	3570	7140	7650	3825	7650
100/25.4	10080	5040	10080	10800	5400	10800
150/38.1	15540	7770	15540	16650	8325	16650
200/50.8	20580	10290	20580	22050	11025	22050
300/76.2	31080	15540	31080	33300	16650	33300
400/101.6	41580	20790	41580	44550	22275	44550
600/152.4	63000	31500	63000	67500	33750	67500
800/203.2	41580	20790	41580	45500	22750	45500

**帶齒剪切力 Tooth Strength Load**

轉速 rpm	N / cm	轉速 rpm	N / cm	轉速 rpm	N / cm
0	45	500	32	2000	22
20	43	600	30	3000	19
40	42	700	29	4000	17
60	41	800	29	5000	16
80	40	900	28	6000	14
100	40	1000	27	7000	13
200	37	1100	26	8000	12
300	35	1200	26	9000	11
400	33	1500	24	10000	10

**帶輪齒數與輪徑最小限制**

Minimum pulley number of teeth and minimum idler diameter

鋼絲線

Steel Cord

芳綸線

Aramid Cord

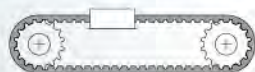
 無反向彎曲傳動  
Drive without reverse bending

 同步輪齒數  
Minimum pulley number of teeth

 帶齒面運轉的張力輪  
Tension roller running on teeth

14 Z

14 Z

60mm

60mm

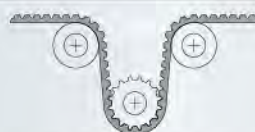
 有反向彎曲傳動  
Drive with reverse bending

 同步輪齒數  
Minimum pulley number of teeth

 帶帶背面上運轉的惰輪  
Tension roller running on belt back

20 Z

20 Z

80mm

80mm

L=Open End 開口帶 J=Jointed 接合帶 F=Flex 無縫帶

## 規格 Specification – XH

皮帶硬度 Shore hardness 92°A

 寬度公差 Width tolerance  $\pm 1.0\text{mm}$ 

 高度公差 Height tolerance  $\pm 0.4\text{mm}$ 

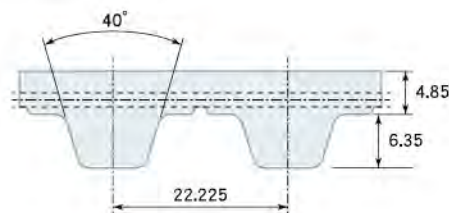
 長度公差 Length tolerance  $\pm 0.5\text{mm/m}$ 

帶寬 Belt width mm	100/25.4	200/50.8	300/76.2	400/101.6	600/152.4
重量 Weight Kg/m	0.370	0.660	0.990	1.330	1.990

### 額定負載 Maximum Tensile Strength (N)

帶寬mm Belt width	鋼絲線 Steel Cord $\varnothing 0.9\text{mm}$			芳綸線 Aramid Cord $\varnothing 1.2\text{mm}$		
	L	J	F	L	J	F
100/25.4	3920	1960	3920	3520	1760	3520
200/50.8	8330	4165	8330	7480	3740	7480
300/76.2	12740	6370	12740	11440	5720	11440
400/101.6	17150	8575	17150	15400	7700	15400
600/152.4	25970	12985	25970	23320	11660	23320

### 斷裂強度 Breaking Strength (N)

帶寬mm Belt width	鋼絲線 Steel Cord $\varnothing 0.9\text{mm}$			芳綸線 Aramid Cord $\varnothing 1.2\text{mm}$		
	L	J	F	L	J	F
100/25.4	15200	7600	15200	16000	8000	16000
200/50.8	32300	16150	32300	34000	17000	34000
300/76.2	49400	24700	49400	52000	26000	52000
400/101.6	66500	33250	66500	70000	35000	70000
600/152.4	100700	50350	100700	106000	53000	106000

### 帶齒剪切力 Tooth Strength Load

轉速 rpm	N / cm	轉速 rpm	N / cm	轉速 rpm	N / cm
0	96	500	62	1400	48
20	92	600	59	1500	47
40	90	700	57	1600	46
60	87	800	55	1700	45
80	85	900	54	1800	44
100	83	1000	52	1900	43
200	74	1100	51	2000	43
300	69	1200	50	3000	37
400	65	1300	49	4000	33

帶齒齒數與輪徑最小限制 Minimum pulley number of teeth and minimum idler diameter	鋼絲線 Steel Cord	芳綸線 Aramid Cord
無反向彎曲傳動 Drive without reverse bending	同步輪齒數 Minimum pulley number of teeth 18 Z	同步輪齒數 Minimum pulley number of teeth 18 Z
有反向彎曲傳動 Drive with reverse bending	帶齒面運轉的張力輪 Tension roller running on teeth 150mm	帶齒面運轉的張力輪 Tension roller running on teeth 150mm
有反向彎曲傳動 Drive with reverse bending	同步輪齒數 Minimum pulley number of teeth 20 Z	同步輪齒數 Minimum pulley number of teeth 20 Z
有反向彎曲傳動 Drive with reverse bending	皮帶背面上運轉的惰輪 Tension roller running on belt back 180mm	皮帶背面上運轉的惰輪 Tension roller running on belt back 180mm

L=Open End 開口帶 J=Jointed 接合帶 F=Flex 無縫帶

### 規格 Specification – 3M

皮帶硬度 Shore hardness 92°A

 寬度公差 Width tolerance  $\pm 0.5$ mm

 高度公差 Height tolerance  $\pm 0.2$ mm

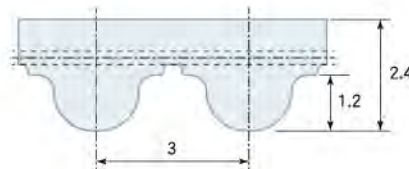
 長度公差 Length tolerance  $\pm 0.5$ mm/m

帶寬 Belt width mm	10	15	25	50	100
重量 Weight Kg/m	0.02	0.03	0.06	0.12	0.24

#### 額定負載 Maximum Tensile Strength (N)

帶寬mm Belt width	鋼絲線 Steel Cord $\varnothing$ 0.3mm	
	L	J
10	320	160
15	510	255
25	900	450
50	1860	930
100	3780	1890

#### 斷裂強度 Breaking Strength (N)

帶寬mm Belt width	鋼絲線 Steel Cord $\varnothing$ 0.3mm	
	L	J
10	1250	625
15	2000	1000
25	3500	1750
50	7250	3625
100	14750	7375

#### 帶齒剪切力 Tooth Strength Load

轉速 rpm	N / cm	轉速 rpm	N / cm	轉速 rpm	N / cm
0	25	500	19	2000	12
20	24	600	18	3000	10
40	24	700	17	4000	8
60	23	800	17	5000	6
80	23	900	16	6000	5
100	22	1000	16	7000	4
200	21	1100	15	8000	3
300	20	1200	15	9000	2
400	19	1500	14	10000	1

#### 帶輪齒數與輪徑最小限制

Minimum pulley number of teeth and minimum idler diameter

 鋼絲線  
Steel Cord

 無反向彎曲傳動  
Drive without reverse bending

 同步輪齒數  
Minimum pulley number of teeth

20 Z

 帶齒面運轉的張力輪  
Tension roller running on teeth

30mm

 有反向彎曲傳動  
Drive with reverse bending

 同步輪齒數  
Minimum pulley number of teeth

20 Z

 皮帶背面上運轉的惰輪  
Tension roller running on belt back

30mm

L=Open End 開口帶 J=Jointed 接合帶

**規格 Specification – 5M**

皮帶硬度 Shore hardness 92°A  
 寬度公差 Width tolerance  $\pm 0.5\text{mm}$   
 高度公差 Height tolerance  $\pm 0.2\text{mm}$   
 長度公差 Length tolerance  $\pm 0.5\text{mm/m}$

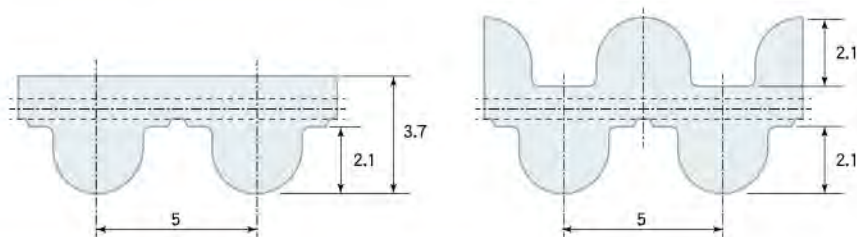

帶寬 Belt width mm	10	15	25	50	75	100
重量 Weight Kg/m	0.05	0.07	0.12	0.24	0.36	0.48

**額定負載 Maximum Tensile Strength (N)**

帶寬mm Belt width	鋼絲線 Steel Cord $\varnothing 0.5\text{mm}$			芳綸線 Aramid Cord $\varnothing 0.6\text{mm}$		
	L	J	F	L	J	F
	10	920	460	920	880	440
15	1500	750	1500	1430	715	1430
25	2650	1325	2650	2530	1265	2530
50	5520	2760	5520	5280	2640	5280
75	8400	4200	8400	8030	4015	8030
100	11270	5635	11270	10780	5390	10780

**斷裂強度 Breaking Strength (N)**

帶寬mm Belt width	鋼絲線 Steel Cord $\varnothing 0.5\text{mm}$			芳綸線 Aramid Cord $\varnothing 0.6\text{mm}$		
	L	J	F	L	J	F
	10	3360	1680	3360	3600	1800
15	5460	2730	5460	5850	2925	5850
25	9660	4830	9660	10350	5175	10350
50	20160	10080	20160	21600	10800	21600
75	30660	15330	30660	32850	16425	32850
100	41160	20580	41160	44100	22050	44100

**帶齒剪切力 Tooth Strength Load**

轉速 rpm	N / cm	轉速 rpm	N / cm	轉速 rpm	N / cm
0	36	500	29	2000	21
20	36	600	28	3000	19
40	35	700	27	4000	17
60	35	800	27	5000	15
80	34	900	26	6000	14
100	34	1000	26	7000	13
200	33	1100	25	8000	12
300	30	1200	25	9000	11
400	30	1500	23	10000	10

**帶輪齒數與輪徑最小限制**

Minimum pulley number of teeth and minimum idler diameter

鋼絲線

Steel Cord

芳綸線

Aramid Cord

 無反向彎曲傳動  
 Drive without reverse bending

 同步輪齒數  
 Minimum pulley number of teeth

16 Z

16 Z

 帶齒面運轉的張力輪  
 Tension roller running on teeth

30mm

30mm

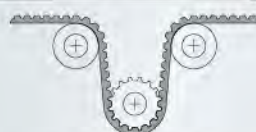
 有反向彎曲傳動  
 Drive with reverse bending

 同步輪齒數  
 Minimum pulley number of teeth

25 Z

25 Z

 皮帶背面上運轉的惰輪  
 Tension roller running on belt back

60mm

60mm

L=Open End 開口帶 J=Jointed 接合帶 F=Flex 無縫帶

**規格 Specification – 8M**

皮帶硬度 Shore hardness 92°A  
 寬度公差 Width tolerance  $\pm 0.5\text{mm}$   
 高度公差 Height tolerance  $\pm 0.2\text{mm}$   
 長度公差 Length tolerance  $\pm 0.5\text{mm/m}$

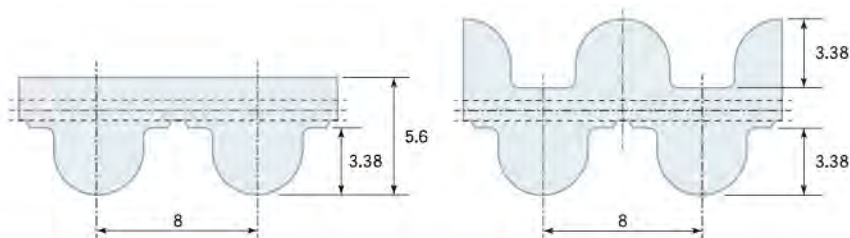

帶寬 Belt width mm	10	15	20	30	50	85	100
重量 Weight Kg/m	0.07	0.10	0.14	0.21	0.35	0.59	0.69

**額定負載 Maximum Tensile Strength (N)**

帶寬mm Belt width	鋼絲線 Steel Cord $\varnothing 0.9\text{mm}$			芳綸線 Aramid Cord $\varnothing 1.2\text{mm}$		
	L	J	F	L	J	F
	10	1470	735	1470	1320	660
15	2210	1105	2210	1980	990	1980
20	3190	1595	3190	2860	1430	2860
30	4660	2330	4660	4180	2090	4180
50	8580	4290	8580	7700	3850	7700
85	14700	7350	14700	13200	6600	13200
100	17400	8700	17400	15620	7810	15620

**斷裂強度 Breaking Strength (N)**

帶寬mm Belt width	鋼絲線 Steel Cord $\varnothing 0.9\text{mm}$			芳綸線 Aramid Cord $\varnothing 1.2\text{mm}$		
	L	J	F	L	J	F
	10	5700	2850	5700	6000	3000
15	8550	4275	8550	9000	4500	9000
20	12350	6175	12350	13000	6500	13000
30	18050	9025	18050	19000	9500	19000
50	33250	16625	33250	35000	17500	35000
85	57000	28500	57000	60000	30000	60000
100	67450	33725	67450	71000	35500	71000

**帶齒剪切力 Tooth Strength Load**

轉速 rpm	N / cm	轉速 rpm	N / cm	轉速 rpm	N / cm
0	74	500	56	1600	41
20	72	600	54	1800	40
40	71	700	52	2000	38
60	70	800	51	3000	32
80	69	900	49	4000	28
100	68	1000	48	4500	26
200	64	1100	47	5000	25
300	61	1200	45	5500	23
400	59	1500	42	6000	22

**帶輪齒數與輪徑最小限制**

Minimum pulley number of teeth and minimum idler diameter

鋼絲線

Steel Cord

芳綸線

Aramid Cord

 無反向彎曲傳動  
 Drive without reverse bending

 同步輪齒數  
 Minimum pulley number of teeth

18 Z

18 Z

 帶齒面運轉的張力輪  
 Tension roller running on teeth

50mm

50mm

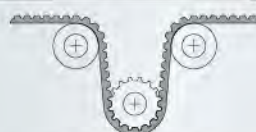
 有反向彎曲傳動  
 Drive with reverse bending

 同步輪齒數  
 Minimum pulley number of teeth

30 Z

30 Z

 皮帶背面上運轉的惰輪  
 Tension roller running on belt back

120mm

120mm

L=Open End 開口帶 J=Jointed 接合帶 F=Flex 無縫帶

### 規格 Specification – 14M

皮帶硬度 Shore hardness 92°A

 寬度公差 Width tolerance  $\pm 1.0\text{mm}$ 

 高度公差 Height tolerance  $\pm 0.4\text{mm}$ 

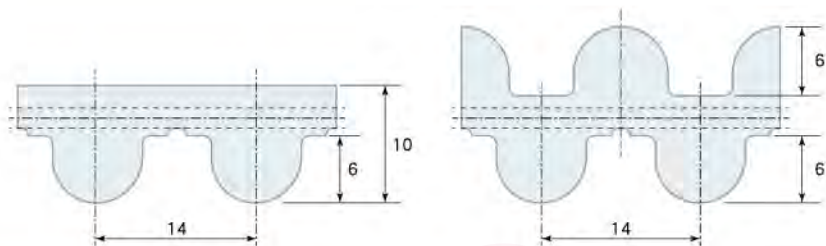
 長度公差 Length tolerance  $\pm 0.5\text{mm/m}$ 

帶寬 Belt width mm	25	40	55	85	115	150
重量 Weight Kg/m	0.28	0.44	0.61	0.94	1.25	1.68

### 額定負載 Maximum Tensile Strength (N)

帶寬mm Belt width	鋼絲線 Steel Cord $\varnothing 1.2\text{mm}$		
	L	J	F
25	5280	2640	5280
40	9120	4560	9120
55	12480	6240	12480
85	19680	9840	19680
115	26880	13440	26880
150	35520	17760	35520

### 斷裂強度 Breaking Strength (N)

帶寬mm Belt width	鋼絲線 Steel Cord $\varnothing 1.2\text{mm}$		
	L	J	F
25	19250	9625	19250
40	33250	16625	33250
55	45500	22750	45500
85	71750	35875	71750
115	98000	49000	98000
150	129500	64750	129500

### 帶齒剪切力 Tooth Strength Load

轉速 rpm	N / cm	轉速 rpm	N / cm	轉速 rpm	N / cm
0	130	500	94	1800	62
20	127	600	90	2000	59
40	125	700	87	2800	49
60	123	800	83	3000	47
80	121	900	80	3200	45
100	120	1000	78	3400	43
200	109	1100	75	3600	41
300	104	1200	73	3800	39
400	99	1500	67	4000	38

帶輪齒數與輪徑最小限制 Minimum pulley number of teeth and minimum idler diameter		鋼絲線 Steel Cord
<p>無反向彎曲傳動 Drive without reverse bending</p>	同步輪齒數 Minimum pulley number of teeth	28 Z
	帶齒面運轉的張力輪 Tension roller running on teeth	120mm
<p>有反向彎曲傳動 Drive with reverse bending</p>	同步輪齒數 Minimum pulley number of teeth	28 Z
	皮帶背面上運轉的惰輪 Tension roller running on belt back	180mm

L=Open End 開口帶 J=Jointed 接合帶 F=Flex 無縫帶



### 規格 Specification – 14ML

皮帶硬度 Shore hardness 92°A  
寬度公差 Width tolerance  $\pm 1.0\text{mm}$   
高度公差 Height tolerance  $\pm 0.5\text{mm}$   
長度公差 Length tolerance  $\pm 0.5\text{mm/m}$

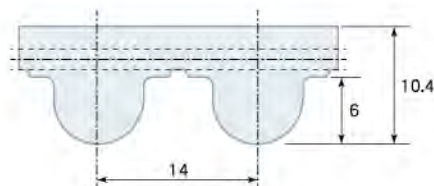

帶寬 Belt width mm	40	55	85	115	150
重量 Weight Kg/m	0.59	0.75	1.29	1.75	2.21

#### 額定負載 Maximum Tensile Strength (N)

帶寬mm Belt width	HP鋼絲線 Steel Cord $\varnothing 1.6\text{mm}$
	L
40	22000
55	32000
85	50000
115	68000
150	90000

#### 斷裂強度 Breaking Strength (N)

帶寬mm Belt width	HP鋼絲線 Steel Cord $\varnothing 1.6\text{mm}$
	L
40	77000
55	112000
85	175000
115	238000
150	315000

#### 帶齒剪切力 Tooth Strength Load

轉速 rpm	N / cm	轉速 rpm	N / cm	轉速 rpm	N / cm
0	130	500	94	1800	62
20	127	600	90	2000	59
40	125	700	87	2800	49
60	123	800	83	3000	47
80	121	900	80	3200	45
100	120	1000	78	3400	43
200	109	1100	75	3600	41
300	104	1200	73	3800	39
400	99	1500	67	4000	38

帶輪齒數與輪徑最小限制 Minimum pulley number of teeth and minimum idler diameter		鋼絲線 Steel Cord
<p>無反向彎曲傳動 Drive without reverse bending</p>	同步輪齒數 Minimum pulley number of teeth	34 Z
	帶齒面運轉的張力輪 Tension roller running on teeth	140mm
<p>有反向彎曲傳動 Drive with reverse bending</p>	同步輪齒數 Minimum pulley number of teeth	34 Z
	皮帶背面上運轉的惰輪 Tension roller running on belt back	200mm

L=Open End 開口帶

### 規格 Specification – S5M

皮帶硬度 Shore hardness 92°A  
 寬度公差 Width tolerance  $\pm 0.5\text{mm}$   
 高度公差 Height tolerance  $\pm 0.2\text{mm}$   
 長度公差 Length tolerance  $\pm 0.5\text{mm/m}$

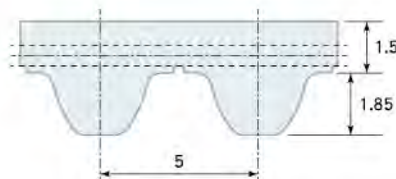

帶寬 Belt width mm	10	15	25	50	100
重量 Weight Kg/m	0.05	0.07	0.12	0.23	0.46

#### 額定負載 Maximum Tensile Strength (N)

帶寬mm Belt width	鋼絲線 Steel Cord $\varnothing 0.5\text{mm}$			芳綸線 Aramid Cord $\varnothing 0.6\text{mm}$		
	L	J	F	L	J	F
	10	920	460	920	880	440
15	1500	750	1500	1430	715	1430
25	2650	1325	2650	2530	1265	2530
50	5520	2760	5520	5280	2640	5280
100	11270	5635	11270	10780	5390	10780

#### 斷裂強度 Breaking Strength (N)

帶寬mm Belt width	鋼絲線 Steel Cord $\varnothing 0.5\text{mm}$			芳綸線 Aramid Cord $\varnothing 0.6\text{mm}$		
	L	J	F	L	J	F
	10	3360	1680	3360	3600	1800
15	5460	2730	5460	5850	2925	5850
25	9660	4830	9660	10350	5175	10350
50	20160	10080	20160	21600	10800	21600
100	41160	20580	41160	44100	22050	44100

#### 帶齒剪切力 Tooth Strength Load

轉速 rpm	N / cm	轉速 rpm	N / cm	轉速 rpm	N / cm
0	36	500	29	2000	22
20	36	600	29	3000	19
40	35	700	28	4000	17
60	35	800	27	5000	16
80	34	900	27	6000	14
100	34	1000	26	7000	13
200	33	1100	26	8000	12
300	31	1200	25	9000	11
400	30	1500	24	10000	11

帶輪齒數與輪徑最小限制 Minimum pulley number of teeth and minimum idler diameter	鋼絲線 Steel Cord	芳綸線 Aramid Cord
 無反向彎曲傳動 Drive without reverse bending	同步輪齒數 Minimum pulley number of teeth 16 Z	16 Z
 帶齒面運轉的張力輪 Tension roller running on teeth	30mm	30mm
 有反向彎曲傳動 Drive with reverse bending	同步輪齒數 Minimum pulley number of teeth 25 Z	25 Z
皮帶背面上運轉的惰輪 Tension roller running on belt back	60mm	60mm

L=Open End 開口帶 J=Jointed 接合帶 F=Flex 無縫帶

**規格 Specification – S8M**

皮帶硬度 Shore hardness 92°A  
 寬度公差 Width tolerance  $\pm 0.5\text{mm}$   
 高度公差 Height tolerance  $\pm 0.2\text{mm}$   
 長度公差 Length tolerance  $\pm 0.5\text{mm/m}$

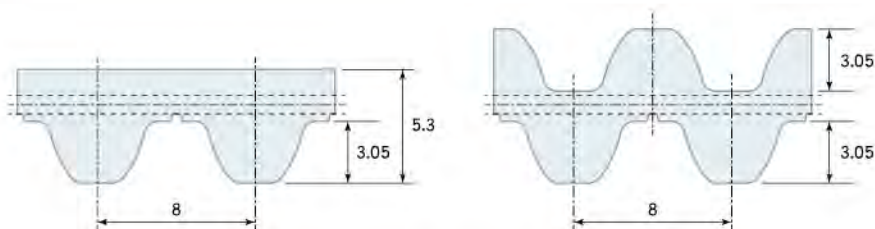

帶寬 Belt width mm	10	15	20	30	50	85	100
重量 Weight Kg/m	0.07	0.10	0.13	0.20	0.33	0.56	0.66

**額定負載 Maximum Tensile Strength (N)**

帶寬mm Belt width	鋼絲線 Steel Cord $\varnothing 0.9\text{mm}$			芳綸線 Aramid Cord $\varnothing 0.9\text{mm}$		
	L	J	F	L	J	F
10	1470	735	1470	1320	660	1320
15	2210	1105	2210	1980	990	1980
20	3190	1595	3190	2860	1430	2860
30	4660	2330	4660	4180	2090	4180
50	8580	4290	8580	7700	3850	7700
85	14700	7350	14700	13200	6600	13200
100	17400	8700	17400	15620	7810	15620

**斷裂強度 Breaking Strength (N)**

帶寬mm Belt width	鋼絲線 Steel Cord $\varnothing 0.9\text{mm}$			芳綸線 Aramid Cord $\varnothing 0.9\text{mm}$		
	L	J	F	L	J	F
10	5700	2850	5700	6000	3000	6000
15	8550	4275	8550	9000	4500	9000
20	12350	6175	12350	13000	6500	13000
30	18050	9025	18050	19000	9500	19000
50	33250	16625	33250	35000	17500	35000
85	57000	28500	57000	60000	30000	60000
100	67450	33725	67450	71000	35500	71000

**帶齒剪切力 Tooth Strength Load**

轉速 rpm	N / cm	轉速 rpm	N / cm	轉速 rpm	N / cm
0	74	500	57	1600	42
20	73	600	55	1800	40
40	72	700	53	2000	39
60	71	800	51	3000	33
80	70	900	50	4000	28
100	69	1000	48	4500	26
200	65	1100	47	5000	25
300	62	1200	46	5500	23
400	59	1500	43	6000	22

帶輪齒數與輪徑最小限制 Minimum pulley number of teeth and minimum idler diameter	鋼絲線 Steel Cord	芳綸線 Aramid Cord
 無反向彎曲傳動 Drive without reverse bending	同步輪齒數 Minimum pulley number of teeth 18 Z	18 Z
 帶齒面運轉的張力輪 Tension roller running on teeth	50mm	50mm
 有反向彎曲傳動 Drive with reverse bending	同步輪齒數 Minimum pulley number of teeth 30 Z	30 Z
 皮帶背面上運轉的惰輪 Tension roller running on belt back	120mm	120mm

L=Open End 開口帶 J=Jointed 接合帶 F=Flex 無縫帶

**規格 Specification – S14M**

皮帶硬度 Shore hardness 92°A  
 寬度公差 Width tolerance  $\pm 1.0\text{mm}$   
 高度公差 Height tolerance  $\pm 0.4\text{mm}$   
 長度公差 Length tolerance  $\pm 0.5\text{mm/m}$

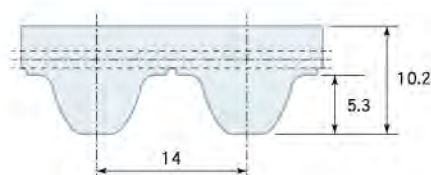

帶寬 Belt width mm	40	55	85	115
重量 Weight Kg/m	0.50	0.70	1.08	1.48

**額定負載 Maximum Tensile Strength (N)**

帶寬mm Belt width	鋼絲線 Steel Cord $\varnothing 1.6\text{mm}$		
	L	J	F
40	12750	6375	12750
55	17850	8925	17850
85	28050	14025	28050
115	39100	19550	39100

**斷裂強度 Breaking Strength (N)**

帶寬mm Belt width	鋼絲線 Steel Cord $\varnothing 1.6\text{mm}$		
	L	J	F
40	48000	24000	48000
55	67200	33600	67200
85	105600	52800	105600
115	147200	73600	147200

**帶齒剪切力 Tooth Strength Load**

轉速 rpm	N / cm	轉速 rpm	N / cm	轉速 rpm	N / cm
0	134	500	99	1800	67
20	131	600	95	2000	64
40	128	700	92	2800	54
60	126	800	89	3000	52
80	124	900	85	3200	50
100	122	1000	83	3400	48
200	114	1100	80	3600	46
300	109	1200	78	3800	44
400	104	1500	72	4000	43

帶輪齒數與輪徑最小限制 Minimum pulley number of teeth and minimum idler diameter		鋼絲線 Steel Cord
 無反向彎曲傳動 Drive without reverse bending	同步輪齒數 Minimum pulley number of teeth	32 Z
	帶齒面運轉的張力輪 Tension roller running on teeth	140mm
 有反向彎曲傳動 Drive with reverse bending	同步輪齒數 Minimum pulley number of teeth	32 Z
	皮帶背面上運轉的惰輪 Tension roller running on belt back	250mm

L=Open End 開口帶 J=Jointed 接合帶 F=Flex 無縫帶

### 規格 Specification – P5M

皮帶硬度 Shore hardness 92°A  
寬度公差 Width tolerance ±0.5mm  
高度公差 Height tolerance ±0.2mm  
長度公差 Length tolerance ±0.5mm/m

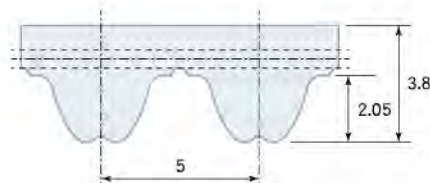

帶寬 Belt width mm	10	15	25	30	50	100
重量 Weight Kg/m	0.05	0.07	0.12	0.15	0.23	0.46

### 額定負載 Maximum Tensile Strength (N)

帶寬mm Belt width	鋼絲線 Steel Cord Ø 0.5mm			芳綸線 Aramid Cord Ø 0.6mm		
	L	J	F	L	J	F
10	920	460	920	880	440	880
15	1500	750	1500	1430	715	1430
25	2650	1325	2650	2530	1265	2530
30	3220	1610	3220	3080	1540	3080
50	5520	2760	5520	5280	2640	5280
100	11270	5635	11270	10780	5390	10780

### 斷裂強度 Breaking Strength (N)

帶寬mm Belt width	鋼絲線 Steel Cord Ø 0.5mm			芳綸線 Aramid Cord Ø 0.6mm		
	L	J	F	L	J	F
10	3360	1680	3360	3600	1800	3600
15	5460	2730	5460	5850	2925	5850
25	9660	4830	9660	10350	5175	10350
30	11760	5880	11760	12600	6300	12600
50	20160	10080	20160	21600	10800	21600
100	41160	20580	41160	44100	22050	44100

帶齒剪切力 Tooth Strength Load					
轉速 rpm	N / cm	轉速 rpm	N / cm	轉速 rpm	N / cm
0	37	500	31	2000	23
20	37	600	30	3000	21
40	36	700	29	4000	19
60	36	800	29	5000	17
80	35	900	28	6000	16
100	35	1000	28	7000	15
200	34	1100	27	8000	14
300	32	1200	27	9000	13
400	32	1500	25	10000	12

帶輪齒數與輪徑最小限制 Minimum pulley number of teeth and minimum idler diameter	鋼絲線 Steel Cord	芳綸線 Aramid Cord
<p>無反向彎曲傳動 Drive without reverse bending</p>	<p>同步輪齒數 Minimum pulley number of teeth</p> <p>帶齒面運轉的張力輪 Tension roller running on teeth</p>	<p>16 Z</p> <p>16 Z</p> <p>30mm</p> <p>30mm</p>
<p>有反向彎曲傳動 Drive with reverse bending</p>	<p>同步輪齒數 Minimum pulley number of teeth</p> <p>皮帶背面上運轉的惰輪 Tension roller running on belt back</p>	<p>25 Z</p> <p>25 Z</p> <p>60mm</p> <p>60mm</p>

L=Open End 開口帶 J=Jointed 接合帶 F=Flex 無縫帶

**規格 Specification – P8M**

皮帶硬度 Shore hardness 92°A  
 寬度公差 Width tolerance  $\pm 0.5\text{mm}$   
 高度公差 Height tolerance  $\pm 0.2\text{mm}$   
 長度公差 Length tolerance  $\pm 0.5\text{mm/m}$

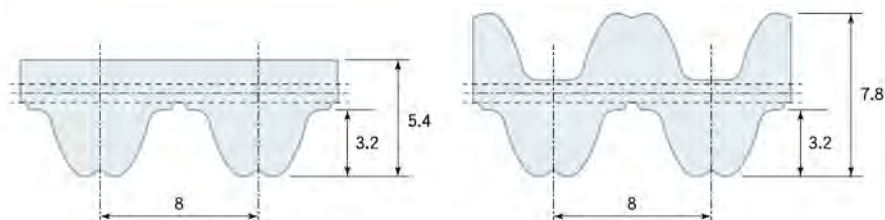

帶寬 Belt width mm	10	15	20	30	50	85	100
重量 Weight Kg/m	0.07	0.10	0.14	0.20	0.35	0.60	0.75

**額定負載 Maximum Tensile Strength (N)**

帶寬mm Belt width	鋼絲線 Steel Cord $\varnothing 0.9\text{mm}$			芳綸線 Aramid Cord $\varnothing 0.9\text{mm}$		
	L	J	F	L	J	F
10	1470	735	1470	1320	660	1320
15	2210	1105	2210	1980	990	1980
20	3190	1595	3190	2860	1430	2860
30	4660	2330	4660	4180	2090	4180
50	8580	4290	8580	7700	3850	7700
85	14700	7350	14700	13200	6600	13200
100	17400	8700	17400	15620	7810	15620

**斷裂強度 Breaking Strength (N)**

帶寬mm Belt width	鋼絲線 Steel Cord $\varnothing 0.9\text{mm}$			芳綸線 Aramid Cord $\varnothing 0.9\text{mm}$		
	L	J	F	L	J	F
10	5700	2850	5700	6000	3000	6000
15	8550	4275	8550	9000	4500	9000
20	12350	6175	12350	13000	6500	13000
30	18050	9025	18050	19000	9500	19000
50	33250	16625	33250	35000	17500	35000
85	57000	28500	57000	60000	30000	60000
100	67450	33725	67450	71000	35500	71000

**帶齒剪切力 Tooth Strength Load**

轉速 rpm	N / cm	轉速 rpm	N / cm	轉速 rpm	N / cm
0	76	500	58	1600	43
20	74	600	56	1800	42
40	73	700	54	2000	40
60	72	800	53	3000	34
80	71	900	51	4000	30
100	70	1000	50	4500	28
200	66	1100	49	5000	27
300	63	1200	47	5500	25
400	61	1500	44	6000	24

帶輪齒數與輪徑最小限制 Minimum pulley number of teeth and minimum idler diameter	鋼絲線 Steel Cord	芳綸線 Aramid Cord
 無反向彎曲傳動 Drive without reverse bending	同步輪齒數 Minimum pulley number of teeth 18 Z	18 Z
 帶齒面運轉的張力輪 Tension roller running on teeth	50mm	50mm
 有反向彎曲傳動 Drive with reverse bending	同步輪齒數 Minimum pulley number of teeth 30 Z	30 Z
 皮帶背面上運轉的惰輪 Tension roller running on belt back	120mm	120mm

L=Open End 開口帶 J=Jointed 接合帶 F=Flex 無縫帶

### 規格 Specification – P14M

皮帶硬度 Shore hardness 92°A  
寬度公差 Width tolerance  $\pm 1.0\text{mm}$   
高度公差 Height tolerance  $\pm 0.4\text{mm}$   
長度公差 Length tolerance  $\pm 0.5\text{mm/m}$

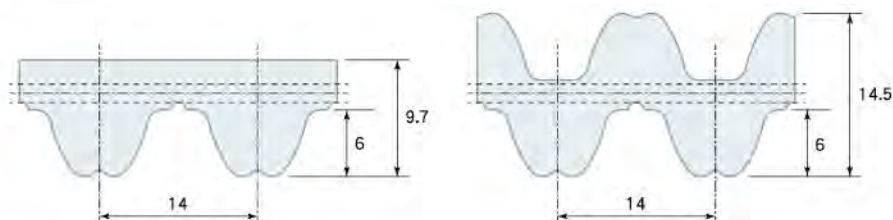

帶寬 Belt width mm	40	55	85	115
重量 Weight Kg/m	0.48	0.68	1.00	1.40

### 額定負載 Maximum Tensile Strength (N)

帶寬mm Belt width	鋼絲線 Steel Cord $\varnothing 1.6\text{mm}$		
	L	J	F
40	12750	6375	12750
55	17850	8925	17850
85	28050	14025	28050
115	39100	19550	39100

### 斷裂強度 Breaking Strength (N)

帶寬mm Belt width	鋼絲線 Steel Cord $\varnothing 1.6\text{mm}$		
	L	J	F
40	48000	24000	48000
55	67200	33600	67200
85	105600	52800	105600
115	147200	73600	147200

### 帶齒剪切力 Tooth Strength Load

轉速 rpm	N / cm	轉速 rpm	N / cm	轉速 rpm	N / cm
0	140	500	104	1800	72
20	137	600	100	2000	69
40	134	700	97	2800	59
60	132	800	93	3000	57
80	130	900	90	3200	55
100	128	1000	88	3400	53
200	119	1100	85	3600	51
300	114	1200	83	3800	49
400	109	1500	77	4000	48

帶輪齒數與輪徑最小限制 Minimum pulley number of teeth and minimum idler diameter		鋼絲線 Steel Cord
<p>無反向彎曲傳動 Drive without reverse bending</p>	同步輪齒數 Minimum pulley number of teeth	32 Z
	帶齒面運轉的張力輪 Tension roller running on teeth	140mm
<p>有反向彎曲傳動 Drive with reverse bending</p>	同步輪齒數 Minimum pulley number of teeth	32 Z
	皮帶背面上運轉的惰輪 Tension roller running on belt back	200mm

L=Open End 開口帶 J=Jointed 接合帶 F=Flex 無縫帶

### 規格 Specification – P14ML

皮帶硬度 Shore hardness 92°A

 寬度公差 Width tolerance  $\pm 1.0\text{mm}$ 

 高度公差 Height tolerance  $\pm 0.4\text{mm}$ 

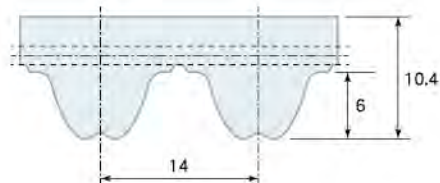
 長度公差 Length tolerance  $\pm 0.5\text{mm/m}$ 

帶寬 Belt width mm	40	55	85	115	150
重量 Weight Kg/m	0.59	0.75	1.29	1.75	2.21

#### 額定負載 Maximum Tensile Strength (N)

#### 斷裂強度 Breaking Strength (N)

帶寬mm Belt width	HP鋼絲線 Steel Cord $\varnothing 1.6\text{mm}$
	L
40	22000
55	32000
85	50000
115	68000
150	90000

帶寬mm Belt width	HP鋼絲線 Steel Cord $\varnothing 1.6\text{mm}$
	L
40	77000
55	112000
85	175000
115	238000
150	315000

#### 帶齒剪切力 Tooth Strength Load

轉速 rpm	N / cm	轉速 rpm	N / cm	轉速 rpm	N / cm
0	140	500	104	1800	72
20	137	600	100	2000	69
40	134	700	97	2800	59
60	132	800	93	3000	57
80	130	900	90	3200	55
100	128	1000	88	3400	53
200	119	1100	85	3600	51
300	114	1200	83	3800	49
400	109	1500	77	4000	48

帶輪齒數與輪徑最小限制 Minimum pulley number of teeth and minimum idler diameter	鋼絲線 Steel Cord
 無反向彎曲傳動 Drive without reverse bending	同步輪齒數 Minimum pulley number of teeth: 34 Z
 有反向彎曲傳動 Drive with reverse bending	帶齒面運轉的張力輪 Tension roller running on teeth: 140mm
 有反向彎曲傳動 Drive with reverse bending	同步輪齒數 Minimum pulley number of teeth: 34 Z
 有反向彎曲傳動 Drive with reverse bending	皮帶背面上運轉的惰輪 Tension roller running on belt back: 250mm

L=Open End 開口帶



## 規格 Specification – TK5 / K6

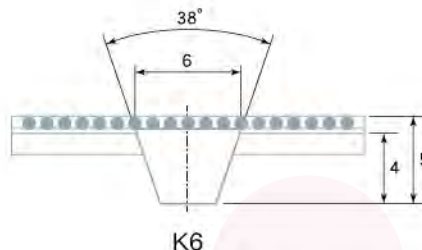
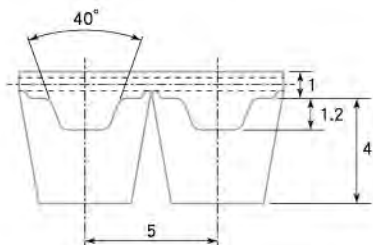

帶寬 Belt width mm	32	50	75	100	寬度公差 Width tolerance	±0.5mm
重量 Weight Kg/m	0.08	0.13	0.20	0.26	長度公差 Length tolerance	±0.5mm/m

## 額定負載 Maximum Tensile Strength (N)

帶寬mm Belt width	鋼絲線 Steel Cord Ø 0.3mm			芳綸線 Aramid Cord Ø 0.3mm		
	L	J	F	L	J	F
32	1150	575	1150	2520	1260	2520
50	1860	930	1860	4060	2030	4060
75	2820	1410	2820	6160	3080	6160
100	3780	1890	3780	8260	4130	8260

Pulley profile

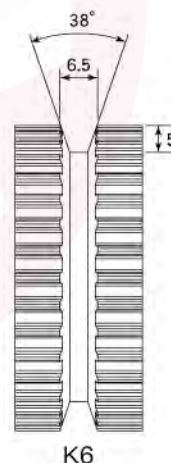

## 斷裂強度 Breaking Strength (N)

帶寬mm Belt width	鋼絲線 Steel Cord Ø 0.3mm			芳綸線 Aramid Cord Ø 0.3mm		
	L	J	F	L	J	F
32	4500	2250	4500	10080	5040	10080
50	7250	3625	7250	16240	8120	16240
75	11000	5500	11000	24640	12320	24640
100	14750	7375	14750	33040	16520	33040

帶輪齒數與輪徑最小限制 Minimum pulley number of teeth and minimum idler diameter		GUIDE
		K6
	同步輪齒數 Minimum pulley number of teeth	14 Z
無反向彎曲傳動 Drive without reverse bending	帶齒面運轉的張力輪 Tension roller running on teeth	40mm
	同步輪齒數 Minimum pulley number of teeth	15 Z
有反向彎曲傳動 Drive with reverse bending	皮帶背面上運轉的惰輪 Tension roller running on belt back	40mm

L=Open End 開口帶 J=Jointed 接合帶 F=Flex 無縫帶

## 規格 Specification – TK10 / K6, K13

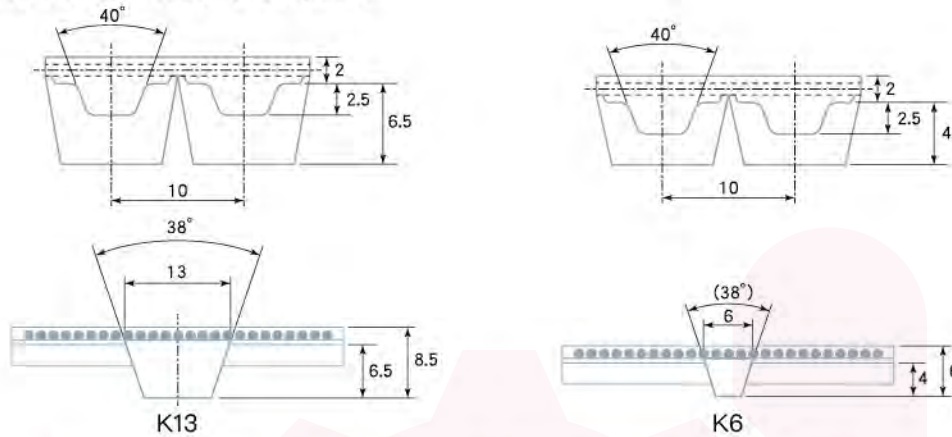

帶寬 Belt width mm	32	50	75	100	150	寬度公差 Width tolerance	±0.5mm
重量 Weight Kg/m	0.22	0.30	0.41	0.53	0.85	長度公差 Length tolerance	±0.5mm/m

## 額定負載 Maximum Tensile Strength (N)

帶寬mm Belt width	鋼絲線 Steel Cord Ø 0.6mm			芳綸線 Aramid Cord Ø 0.6mm		
	L	J	F	L	J	F
32	3450	1725	3450	3300	1650	3300
50	5520	2760	5520	5280	2640	5280
75	8400	4200	8400	8030	4015	8030
100	11270	5635	11270	10780	5390	10780
150	17020	8510	17020	16280	8140	16280

## 斷裂強度 Breaking Strength (N)

帶寬mm Belt width	鋼絲線 Steel Cord Ø 0.6mm			芳綸線 Aramid Cord Ø 0.6mm		
	L	J	F	L	J	F
32	12600	6300	12600	13500	6750	13500
50	20160	10080	20160	21600	10800	21600
75	30660	15330	30660	32850	16425	32850
100	41160	20580	41160	44100	22050	44100
150	62160	31080	62160	66600	33300	66600

## Pulley profile

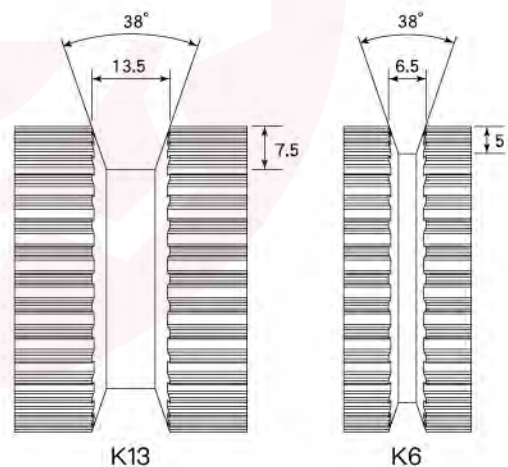

帶輪齒數與輪徑最小限制 Minimum pulley number of teeth and minimum idler diameter		GUIDE	
		K6	K13
無反向彎曲傳動 Drive without reverse bending	同步輪齒數 Minimum pulley number of teeth	14 Z	16 Z
	帶齒面運轉的張力輪 Tension roller running on teeth	60mm	80mm
有反向彎曲傳動 Drive with reverse bending	同步輪齒數 Minimum pulley number of teeth	20 Z	20 Z
	皮帶背面上運轉的惰輪 Tension roller running on belt back	60mm	60mm

L=Open End 開口帶 J=Jointed 接合帶 F=Flex 無縫帶

規格 Specification – ATK5 / K6

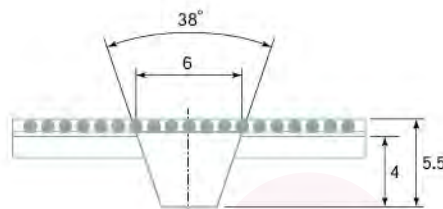
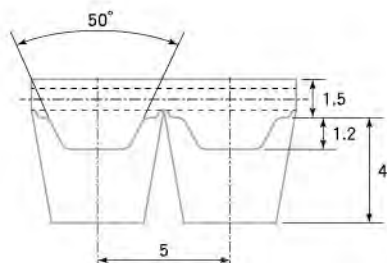

K6

帶寬 Belt width mm	32	50	75	100	寬度公差 Width tolerance	±0.5mm
重量 Weight Kg/m	0.11	0.19	0.29	0.38	長度公差 Length tolerance	±0.5mm/m

額定負載 Maximum Tensile Strength (N)

帶寬mm Belt width	鋼絲線 Steel Cord Ø 0.5mm			芳綸線 Aramid Cord Ø 0.6mm		
	L	J	F	L	J	F
32	3450	1725	3450	3300	1650	3300
50	5520	2760	5520	5280	2640	5280
75	8400	4200	8400	8030	4015	8030
100	11270	5635	11270	10780	5390	10780

斷裂強度 Breaking Strength (N)

帶寬mm Belt width	鋼絲線 Steel Cord Ø 0.5mm			芳綸線 Aramid Cord Ø 0.6mm		
	L	J	F	L	J	F
32	12600	6300	12600	13500	6750	13500
50	20160	10080	20160	21600	10800	21600
75	30660	15330	30660	32850	16425	32850
100	41160	20580	41160	44100	22050	44100

Pulley profile

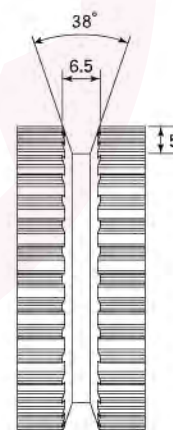

K6

帶輪齒數與輪徑最小限制 Minimum pulley number of teeth and minimum idler diameter		GUIDE
		K6
	同步輪齒數 Minimum pulley number of teeth	25 Z
無反向彎曲傳動 Drive without reverse bending	帶齒面運轉的張力輪 Tension roller running on teeth	60mm
	同步輪齒數 Minimum pulley number of teeth	25 Z
有反向彎曲傳動 Drive with reverse bending	皮帶背面上運轉的惰輪 Tension roller running on belt back	80mm

L=Open End 開口帶 J=Jointed 接合帶 F=Flex 無縫帶

## 規格 Specification – ATK10 / K6, K13

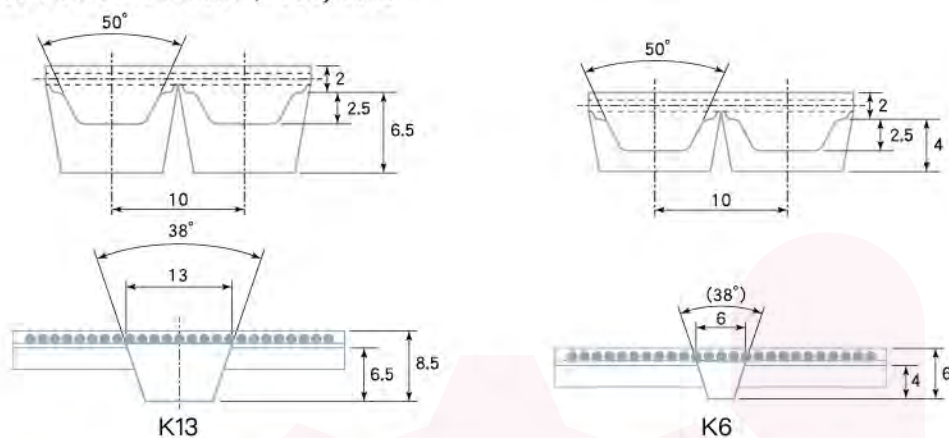

帶寬 Belt width mm	32	50	75	100	150	寬度公差 Width tolerance	±0.5mm
重量 Weight Kg/m	0.27	0.36	0.50	0.72	1.08	長度公差 Length tolerance	±0.5mm/m

## 額定負載 Maximum Tensile Strength (N)

帶寬mm Belt width	鋼絲線 Steel Cord Ø 0.9mm			芳綸線 Aramid Cord Ø 0.9mm		
	L	J	F	L	J	F
32	5390	2695	5390	4840	2420	4840
50	8580	4290	8580	7700	3850	7700
75	12990	6495	12990	11660	5830	11660
100	17400	8700	17400	15620	7810	15620
150	26220	13110	26220	23540	11770	23540

## Pulley profile

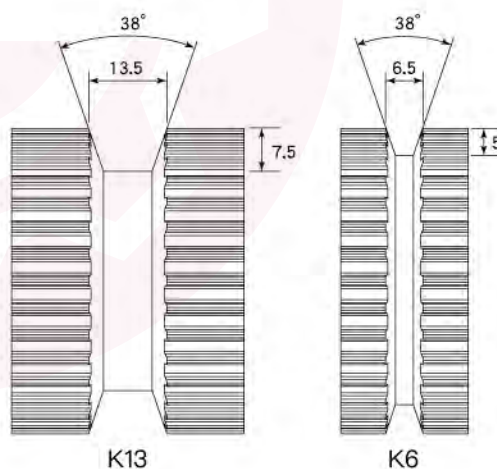

## 斷裂強度 Breaking Strength (N)

帶寬mm Belt width	鋼絲線 Steel Cord Ø 0.9mm			芳綸線 Aramid Cord Ø 0.9mm		
	L	J	F	L	J	F
32	20900	10450	20900	22000	11000	22000
50	33250	16625	33250	35000	17500	35000
75	50350	25175	50350	53000	26500	53000
100	67450	33725	67450	71000	35500	71000
150	101650	50825	101650	107000	53500	107000

帶輪齒數與輪徑最小限制 Minimum pulley number of teeth and minimum idler diameter		GUIDE	
		K6	K13
 無反向彎曲傳動 Drive without reverse bending	同步輪齒數 Minimum pulley number of teeth	15 Z	17 Z
	帶齒面運轉的張力輪 Tension roller running on teeth	50mm	50mm
 有反向彎曲傳動 Drive with reverse bending	同步輪齒數 Minimum pulley number of teeth	25 Z	25 Z
	皮帶背面上運轉的惰輪 Tension roller running on belt back	120mm	120mm

L=Open End 開口帶 J=Jointed 接合帶 F=Flex 無縫帶

**規格 Specification – F1, F2, F2.5, F3**

皮帶硬度 Shore hardness 92°A  
 寬度公差 Width tolerance±0.5mm  
 高度公差 Height tolerance±0.2mm  
 長度公差 Length tolerance±0.8mm/m

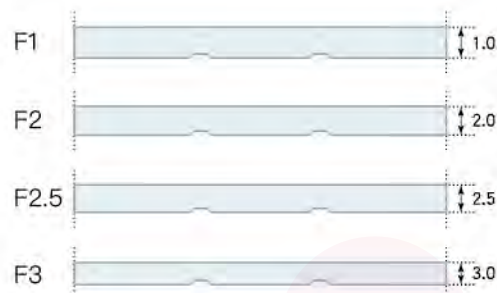
**F1 鋼絲線 Steel Cord Ø 0.3mm**

帶寬 Belt width mm	10	20	30	40	50	100
重量 Weight Kg/m	0.02	0.04	0.05	0.08	0.09	0.21
額定負載 (N) Maximum Tensile Strength	320	700	1090	1470	1860	3780
斷裂強度 (N) Breaking Strength	1250	2750	4250	5750	7250	14750

**最小輪徑限制 Minimum pulley diameter**

 無反向彎曲傳動 mm  
 Drive without reverse bending 16

 有反向彎曲傳動 mm  
 Drive with reverse bending 30

**F2 鋼絲線 Steel Cord Ø 0.9mm**

帶寬 Belt width mm	15	25	30	50	75	100
重量 Weight Kg/m	0.05	0.08	0.10	0.17	0.25	0.34
額定負載 (N) Maximum Tensile Strength	2210	4170	4660	8580	12990	17400
斷裂強度 (N) Breaking Strength	8550	16150	18050	33250	50350	67450

**最小輪徑限制 Minimum pulley diameter**

 無反向彎曲傳動 mm  
 Drive without reverse bending 50

 有反向彎曲傳動 mm  
 Drive with reverse bending 100

**F2.5 鋼絲線 Steel Cord Ø 1.2mm**

帶寬 Belt width mm	20	25	50	75	100	120
重量 Weight Kg/m	0.08	0.09	0.18	0.27	0.36	0.42
額定負載 (N) Maximum Tensile Strength	5280	6720	14400	21600	29280	35040
斷裂強度 (N) Breaking Strength	19250	24500	52500	78750	106750	127750

**最小輪徑限制 Minimum pulley diameter**

 無反向彎曲傳動 mm  
 Drive without reverse bending 80

 有反向彎曲傳動 mm  
 Drive with reverse bending 150

**F3 鋼絲線 Steel Cord Ø 1.6mm**

帶寬 Belt width mm	25	30	60	120	150
重量 Weight Kg/m	0.11	0.12	0.24	0.48	0.60
額定負載 (N) Maximum Tensile Strength	8500	10200	21250	43350	53550
斷裂強度 (N) Breaking Strength	32000	38400	80000	163200	201600

**最小輪徑限制 Minimum pulley diameter**

 無反向彎曲傳動 mm  
 Drive without reverse bending 120

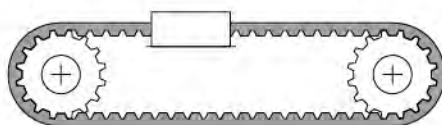
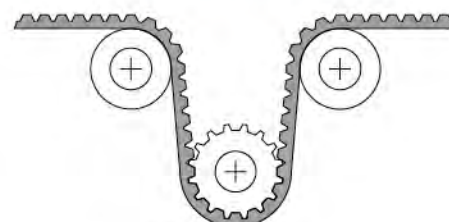
 有反向彎曲傳動 mm  
 Drive with reverse bending 180

 無反向彎曲傳動  
 Drive without reverse bending

 有反向彎曲傳動  
 Drive with reverse bending